

# PRIMINER

## VERTICAL MACHINING CENTERS

PRECISE · DYNAMIC · RELIABLE

Top price/performance ratio

High-quality components

Numerous options



**VMC**  
Each machine is  
customized for your production.



MINI CENTER



Delta Center V6L



Delta Center T7



Delta Center V10L



Alpha Center V7L



Alpha Center V9L/V11L



Alpha Center V13L / V15L



Power Center V18



U500 / GT7



VF760



VF900



VF1100 / VF1300  
/ VF1500



GT18 / GT18-5X



V1613HS/V2013HS



V2013 / V2317 / V3025 /  
V3317 / V4025



# PRIMINER

## The Company



Jack Chen | CEO Priminer Company Group  
Benjamin Kaehlcke | General Manager, Germany



**PRIMINER** |||

**PRIMINER** |||

**PRIMINER** |||



## We stay up to date

“Only employees which are regular trained and involved in the development of our production process can understand the requirements of present and future as a whole.” According to Mr. Kaehlcke GF of Priminer Germany. “This is the case for our German and China team members. We have an intensive exchange program between our two major spots, additional to our permanent training course at our global leading sub-suppliers.”





# ▶ HOW WE DO IT

Consequent QC-management according to international norms, a highly motivated team of specialists, advantages of serial production and reliable top sub-suppliers with global leading positions are columns of our success. An open and result-oriented company culture through all levels is the basement for a permanent high level of our reliability and products.



## Our Team

International, competent, highly motivated and always open for new ideas... This is our team. The cooperate culture is a mirror of these attitudes. Our management has got a "open ear" from bottom to top and we are and we practise flat hierarchy.

# PRIMIN

PRIMINER



# ER Global TEAM



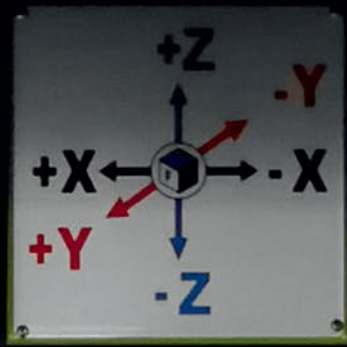

# OUR KNOW-HOW FOR YOUR BUSINESS

## Technology & Know-how

We think and plan the future already now. A growing in-house R&D department with experienced engineers which develop our machine concepts are our warrantor that we are prepared for the upcoming trends of the machine tools business. We are listening to the market. Flexibility in the matter of CNC controllers is for us a must, here we only go with the market leaders. Without any compromise!

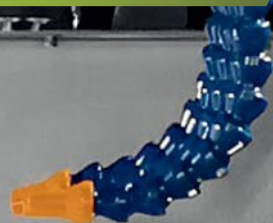





## GT18

- High speed and high precision machining, widely applied for big die & mold, electronics, defense, aerospace and medical industry
- Extra wide machine column and base design ensures the high rigidity
- Dual drive system with two ballscrews and three linear guideways on Y axis to ensure high accuracy of machining
- Extra wide door for easy loading and unloading
- Built-in type spindle, HSK A63, 24000rpm
- Oil cooled ballscrew
- Heidenhain linear scales on three axes
- 60 pockets chain type servo tool changer

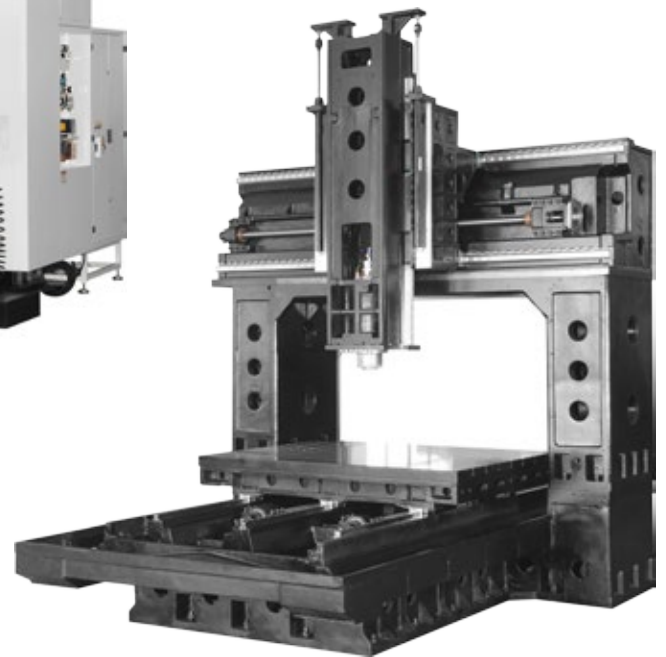

Technical Specifications		GT18
<b>Table</b>		
Table size	mm	1800 x 1400
T-slot (width x number x distance)	mm	22 x 7 x 170
Max. load	kg	6000
<b>Travel</b>		
X/Y/Z Travel	mm	1800 / 1400 / 800
Spindle nose to table	mm	200 - 1000
Distance between columns	mm	1960
<b>Spindle</b>		
Spindle taper	-	HSK A63
Spindle servo motor	kW	21/27
Spindle speed	rpm	24000
<b>Feed</b>		
Rapid feed X/Y/Z	m/min	30
Cutting speed	mm/min	1-12000
<b>Tool changer</b>		
Number of tools	pcs	60
Max. tool length	mm	300
Max. tool diameter	mm	78 / 150 (next release)
Max. tool weight	kg	8
<b>Accuracy (VDI 3441)</b>		
Positioning accuracy (with linear encoder)	mm	0.010 / Full travel
Repeatability accuracy (with linear encoder)	mm	0.006 / Full travel
<b>Dimensions &amp; Weight</b>		
Dimensions	mm	4965 x 6100 x 4380
Weight	kg	22000

Standard configuration:	
✓ Full enclosed splash guard	✓ Ethernet, CF card and USB interface
✓ Motor spindle HSK A63 24000 rpm	✓ Automatic lubrication system
✓ 60 pockets chain type tool changer	✓ Coolant system
✓ Chip conveyor (two screw type and one chain type)	✓ Air blast during cutting
✓ Air-conditioned electrical cabinet	✓ LED working lamp
✓ High precision spindle water cooler	✓ End of program light
✓ Linear scales	✓ Electronic handwheel (MPG)
✓ Rigid tapping	✓ Tool box
	✓ Leveling bolts and blocks
	✓ Coolant gun
	✓ Air gun
	✓ User Manual

Optional configuration:	
■ Motor spindle HSK A100, 12000 rpm	
■ CTS Coolant through spindle + ATS	
■ Oil cooled ballscrew	
■ Oil skimmer	
■ Workpiece probe	
■ Tool probe	

\* The above specifications are subject to change without prior notice, no liability for mistakes. Machines may be shown with optional equipment.

Worktable

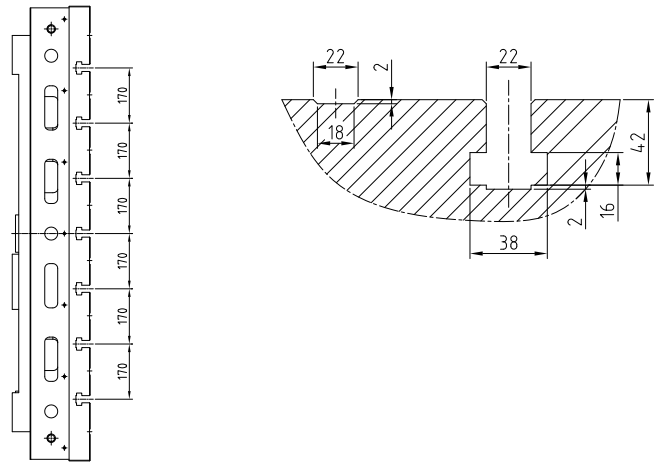
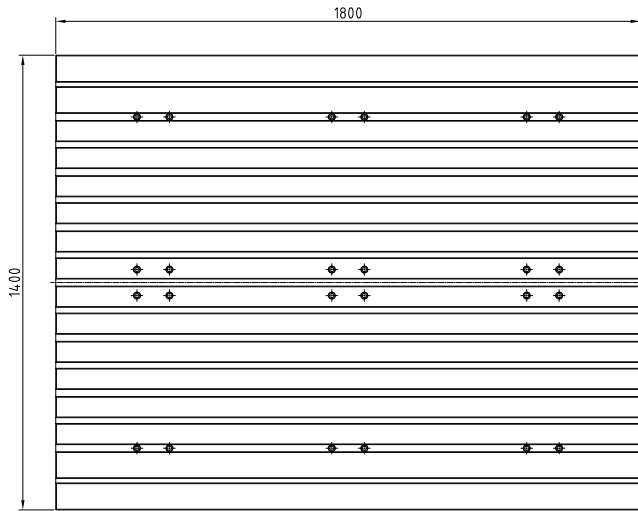

Dimensions

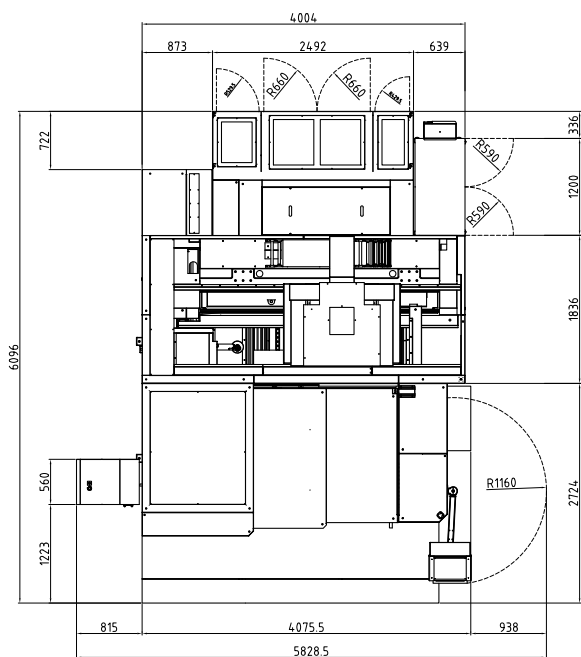
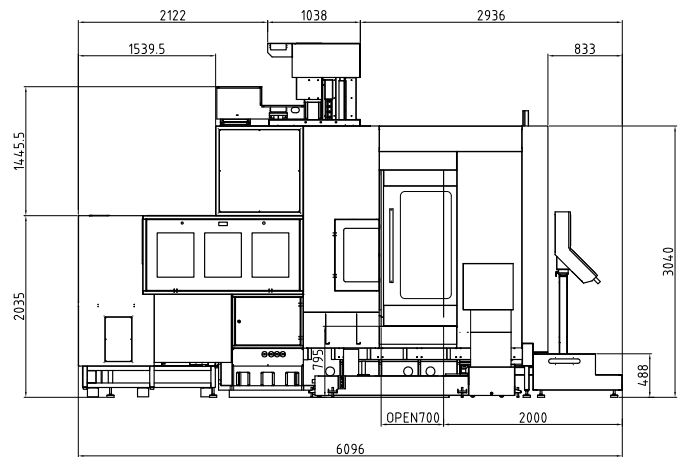
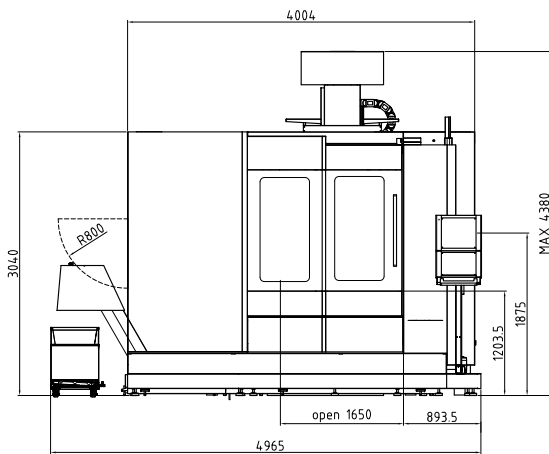

\* The above specifications are subject to change without prior notice, no liability for mistakes. Machines may be shown with optional equipment.

# GT18-5X



Technical Specifications		GT18-5X
<b>Table</b>		
Table size	mm	1800 x 1400
T-slot (width x number x distance)	mm	22 x 7 x 170
Max. load	kg	6000
A/C Axis Rotation	-	±110° / ±270°
<b>Travel</b>		
X/Y/Z Travel	mm	2000 / 1400 / 800
Spindle nose to table	mm	200 - 1000
<b>Spindle</b>		
Spindle taper	-	HSK A63
Spindle servo motor	kW	40 / 48
Spindle speed	rpm	24000
Max. speed A/C Axis	°/sec	180 / 180
<b>Feed</b>		
Rapid feed X/Y/Z	m/min	30
Cutting speed	mm/min	1-12000
<b>Tool changer</b>		
Number of tools	pcs	60
Max. tool length	mm	300
Max. tool diameter	mm	78 / 150 (next release)
Max. tool weight	kg	8
<b>Accuracy (VDI 3441)</b>		
Positioning accuracy (with linear encoder)	mm	0.010 / Full travel
Repeatability accuracy (with linear encoder)	mm	0.006 / Full travel
<b>Dimensions &amp; Weight</b>		
Dimensions	mm	4965 x 6100 x 4830
Weight	kg	24000

- Built-in type spindle, HSK A63, 24000 rpm
- 60 pockets chain type servo tool changer
- Heidenhain linear scales on three axes
- Oil cooled ballscrew
- Direct drive servo motor for A/C axes
- A axis travel: ±110°
- C axis travel: ±270°
- A axis clamping torque: 1800 Nm
- C axis clamping torque: 2000 Nm

#### Standard configuration:

- ✓ Full enclosed splash guard
- ✓ Motor spindle HSK A63 24000 rpm
- ✓ 60 pockets chain type tool changer
- ✓ Chip conveyor (two screw type and one chain type)
- ✓ Air-conditioned electrical cabinet
- ✓ High precision spindle water cooler
- ✓ Linear scales
- ✓ Rigid tapping
- ✓ Ethernet, CF card and USB interface
- ✓ Automatic lubrication system
- ✓ Coolant system
- ✓ Air blast during cutting
- ✓ LED working lamp
- ✓ End of program light
- ✓ Electronic handwheel (MPG)
- ✓ Tool box
- ✓ Leveling bolts and blocks
- ✓ Coolant gun
- ✓ Air gun
- ✓ User Manual

#### Optional configuration:

- CTS Coolant through spindle + ATS
- Oil cooled ballscrew
- Oil skimmer
- Workpiece probe
- Tool probe

\* The above specifications are subject to change without prior notice, no liability for mistakes. Machines may be shown with optional equipment.

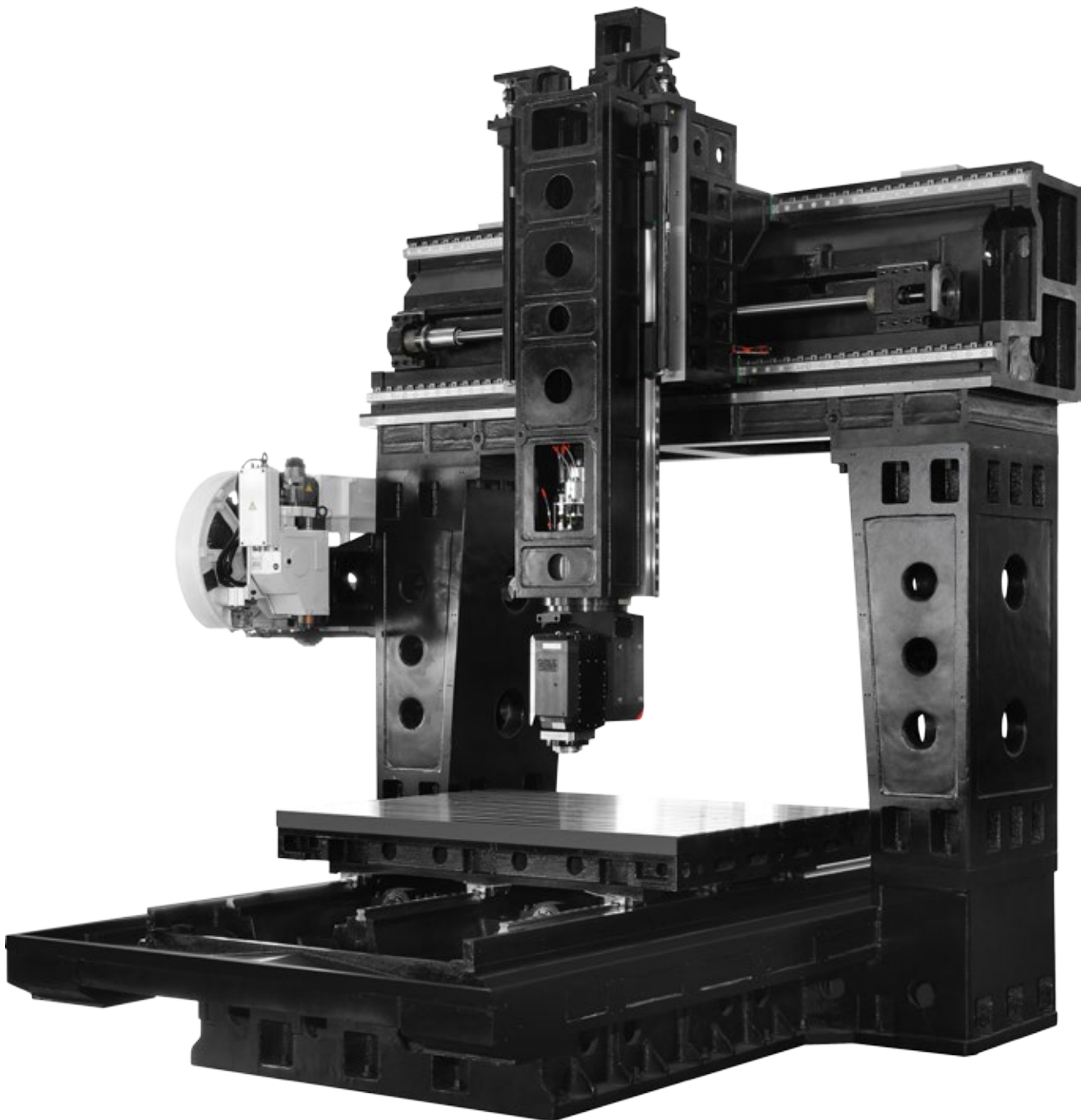
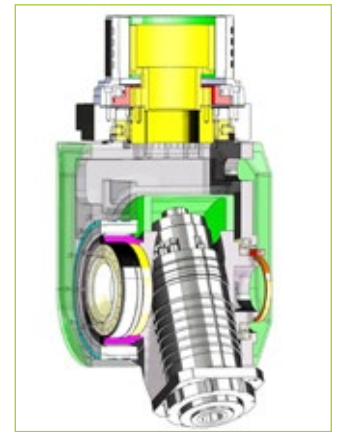

\* The above specifications are subject to change without prior notice, no liability for mistakes. Machines may be shown with optional equipment.

## U500

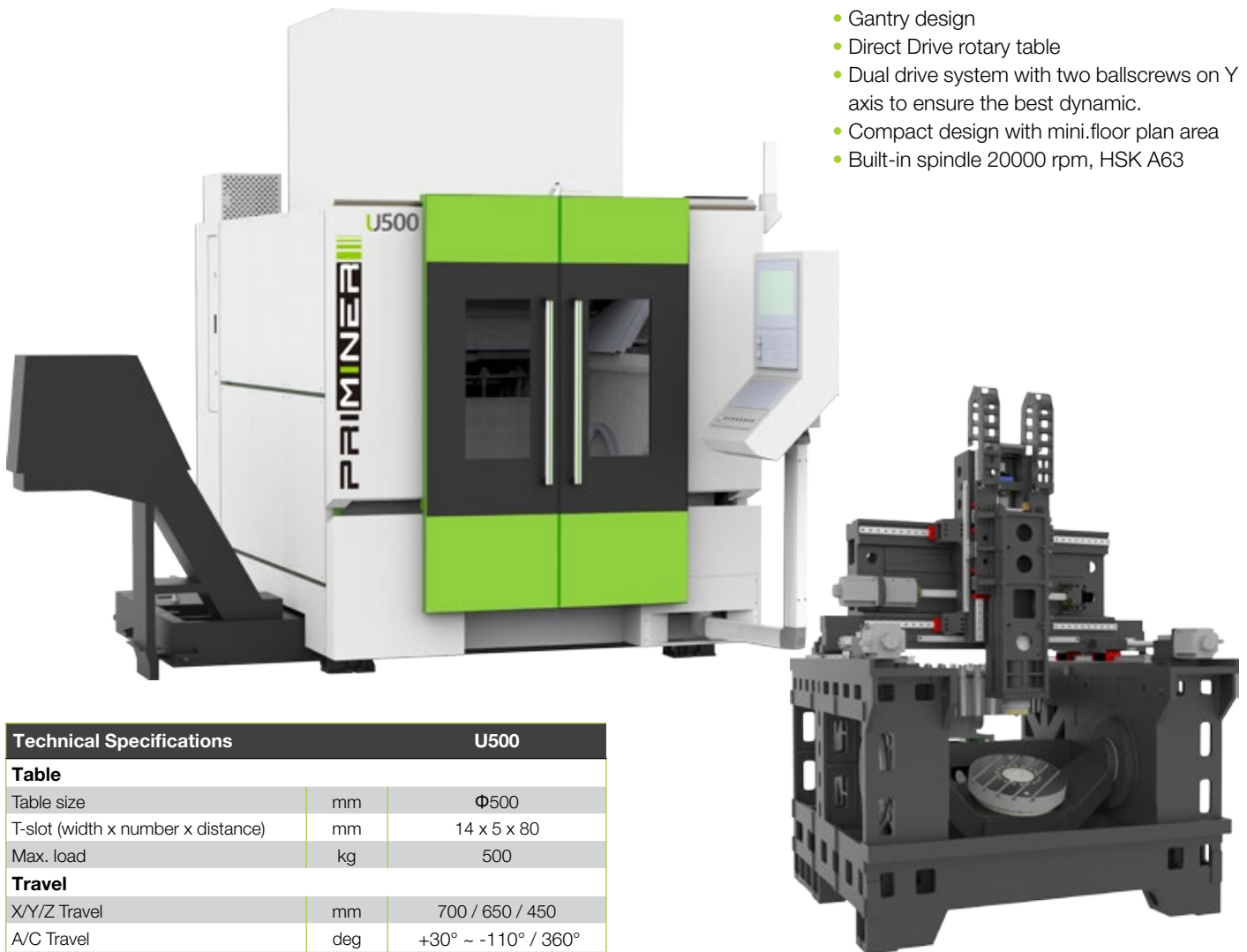

- Gantry design
- Direct Drive rotary table
- Dual drive system with two ballscrews on Y axis to ensure the best dynamic.
- Compact design with mini.floor plan area
- Built-in spindle 20000 rpm, HSK A63

Technical Specifications		U500
<b>Table</b>		
Table size	mm	Φ500
T-slot (width x number x distance)	mm	14 x 5 x 80
Max. load	kg	500
<b>Travel</b>		
X/Y/Z Travel	mm	700 / 650 / 450
A/C Travel	deg	+30° ~ -110° / 360°
Spindle nose to table	mm	120 - 570
<b>Spindle</b>		
Spindle taper	-	HSK A63
Spindle servo motor	kW	20 / 24
Spindle speed	rpm	20000
<b>Feed</b>		
Rapid feed X/Y/Z	m/min	15
Rapid feed A/C	rpm	100 / 170
Cutting speed	mm/min	1-12000
<b>Tool changer</b>		
Number of tools	pcs	24
Max. tool length	mm	250
Max. tool diameter	mm	63
Max. tool weight	kg	4
<b>Accuracy (VDI 3441)</b>		
Positioning accuracy (with linear encoder)	mm	0.006 / Full travel
Repeatability accuracy (with linear encoder)	mm	0.003 / Full travel
<b>Dimensions &amp; Weight</b>		
Dimensions	mm	3586 x 2803 x 3030
Weight	kg	9000

### Standard configuration:

- ✓ Full enclosed splash guard
- ✓ Motor spindle HSK A63 20000 rpm
- ✓ 24 pockets chain type tool changer
- ✓ Chain type chip conveyor
- ✓ Air-conditioned electrical cabinet
- ✓ High precision spindle water cooler
- ✓ Linear scales
- ✓ Rigid tapping
- ✓ Ethernet ,CF card and USB interface
- ✓ Automatic lubrication system
- ✓ Coolant system
- ✓ Air blast during cutting
- ✓ LED working lamp
- ✓ End of program light
- ✓ Electronic handwheel(MPG)
- ✓ Tool box
- ✓ Leveling bolts and blocks
- ✓ Coolant gun
- ✓ Air gun
- ✓ User Manual

### Optional configuration:

- Motor spindle HSK E40 30000 rpm with 40 pockets chain type tool changer
- CTS Coolant through spindle + ATS
- Oil cooled ballscrew
- Oil skimmer
- Workpiece probe
- Tool probe

Cutting Area and Interference Area

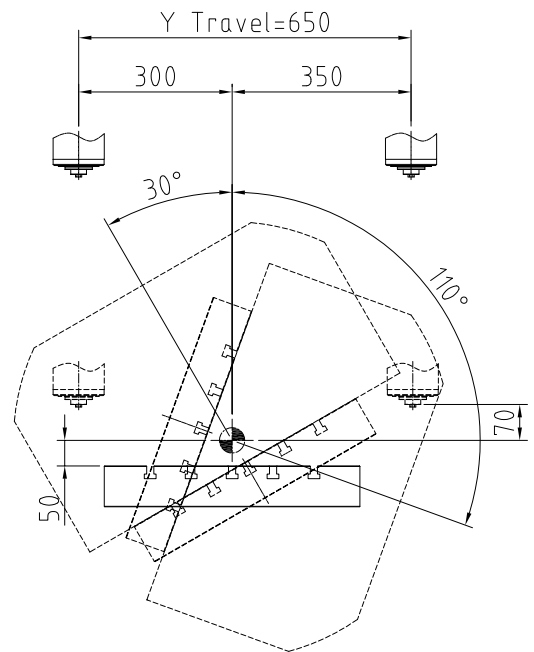
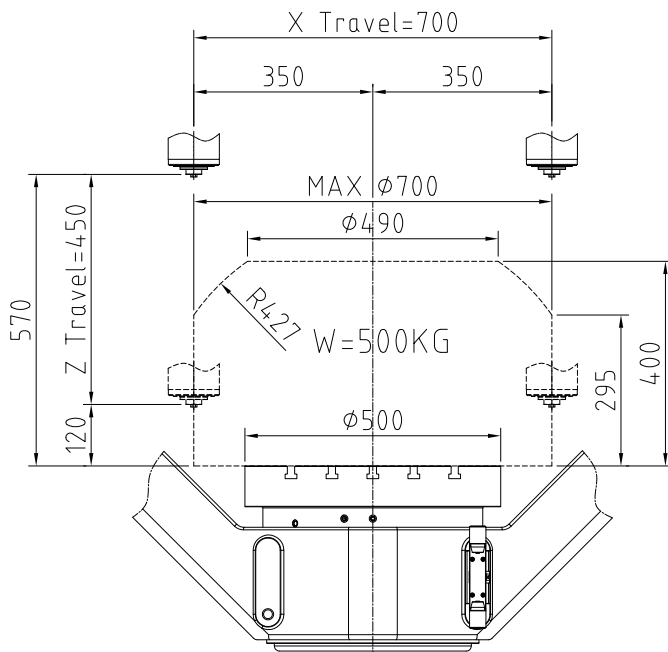

Dimensions

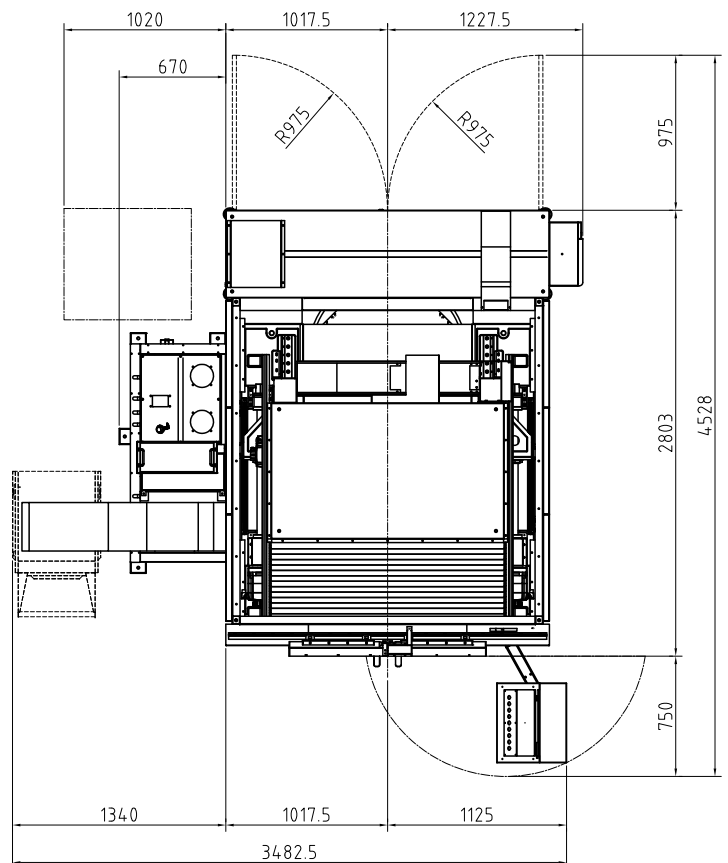
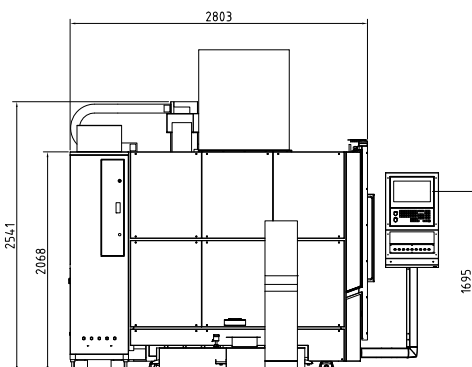
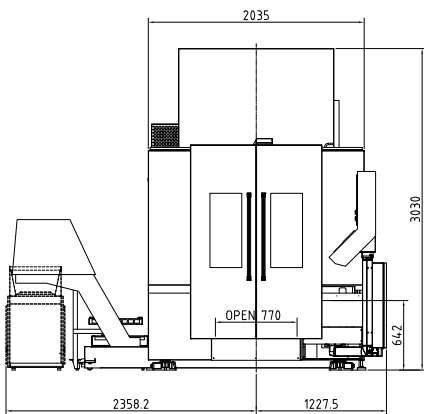

\* The above specifications are subject to change without prior notice, no liability for mistakes. Machines may be shown with optional equipment.

## GT7

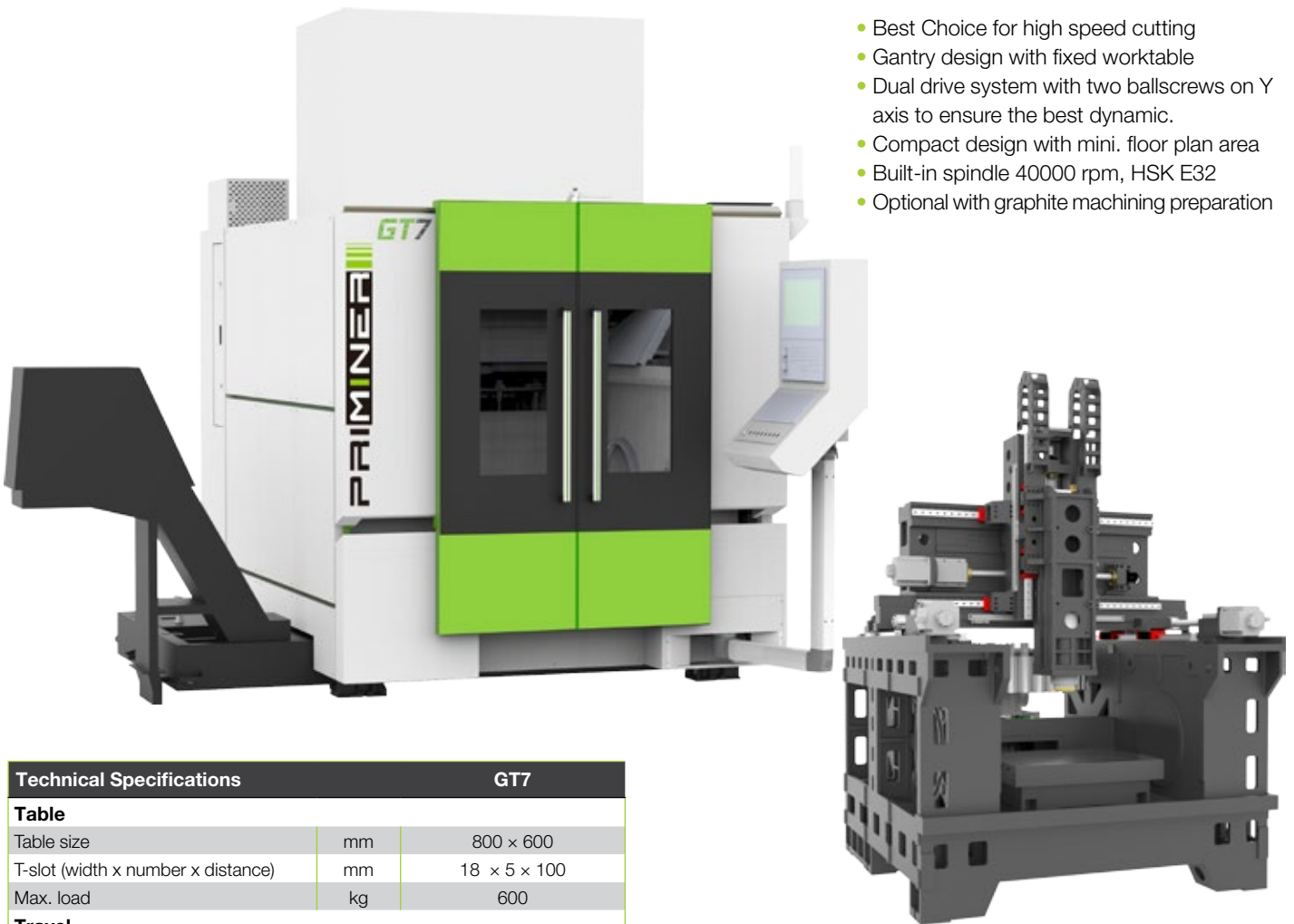

- Best Choice for high speed cutting
- Gantry design with fixed worktable
- Dual drive system with two ballscrews on Y axis to ensure the best dynamic.
- Compact design with mini. floor plan area
- Built-in spindle 40000 rpm, HSK E32
- Optional with graphite machining preparation

Technical Specifications		GT7
<b>Table</b>		
Table size	mm	800 × 600
T-slot (width x number x distance)	mm	18 × 5 × 100
Max. load	kg	600
<b>Travel</b>		
X/Y/Z Travel	mm	700 / 600 / 450
Spindle nose to table	mm	145 - 595
Distance between columns	mm	-
<b>Spindle</b>		
Spindle taper	-	HSK E32
Spindle servo motor	kW	6.3 / 9.45
Spindle speed	rpm	40000
<b>Feed</b>		
Rapid feed X/Y/Z	m/min	15
Cutting speed	mm/min	1-12000
<b>Tool changer</b>		
Number of tools	pcs	32
Max. tool length	mm	250
Max. tool diameter	mm	12
Max. tool weight	kg	2
<b>Accuracy (VDI 3441)</b>		
Positioning accuracy (with linear encoder)	mm	0.006 / Full travel
Repeatability accuracy (with linear encoder)	mm	0.003 / Full travel
<b>Dimensions &amp; Weight</b>		
Dimensions	mm	3586 x 2803 x 3030
Weight	kg	8000

### Standard configuration:

- ✓ Full enclosed splash guard
- ✓ Motor spindle HSK E32 40000 rpm
- ✓ 48 pockets chain type tool changer
- ✓ Chain type chip conveyor
- ✓ Air-conditioned electrical cabinet
- ✓ High precision spindle water cooler
- ✓ Linear scales
- ✓ Rigid tapping
- ✓ Ethernet, CF card and USB interface
- ✓ Automatic lubrication system
- ✓ Coolant system
- ✓ Air blast during cutting
- ✓ LED working lamp
- ✓ End of program light
- ✓ Electronic handwheel (MPG)
- ✓ Tool box
- ✓ Leveling bolts and blocks
- ✓ Coolant gun
- ✓ Air gun
- ✓ User Manual

### Optional configuration:

- HSK E40 30000 rpm with 40 pockets chain type tool changer
- HSK A63 20000 rpm with 24 pockets chain type tool changer
- CTS Coolant through spindle + ATS
- Oil cooled ballscrew
- Oil skimmer
- Workpiece probe
- Tool probe



Worktable

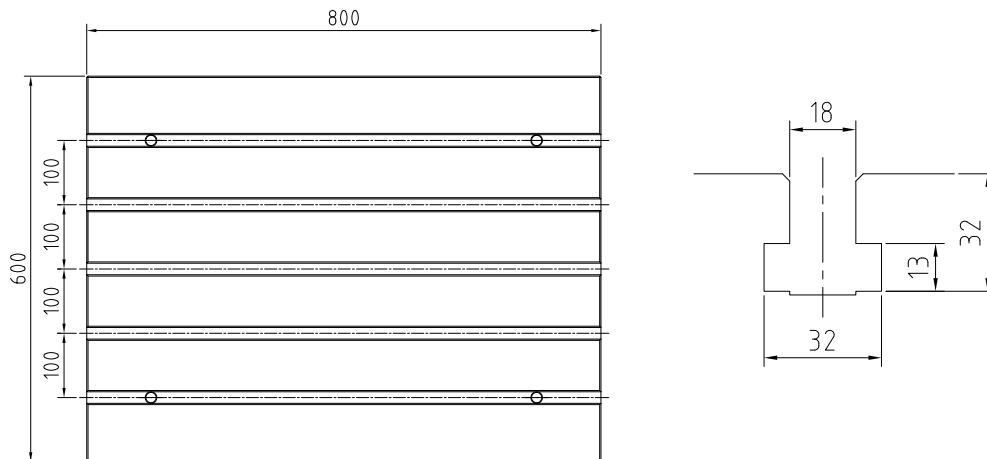

Dimensions

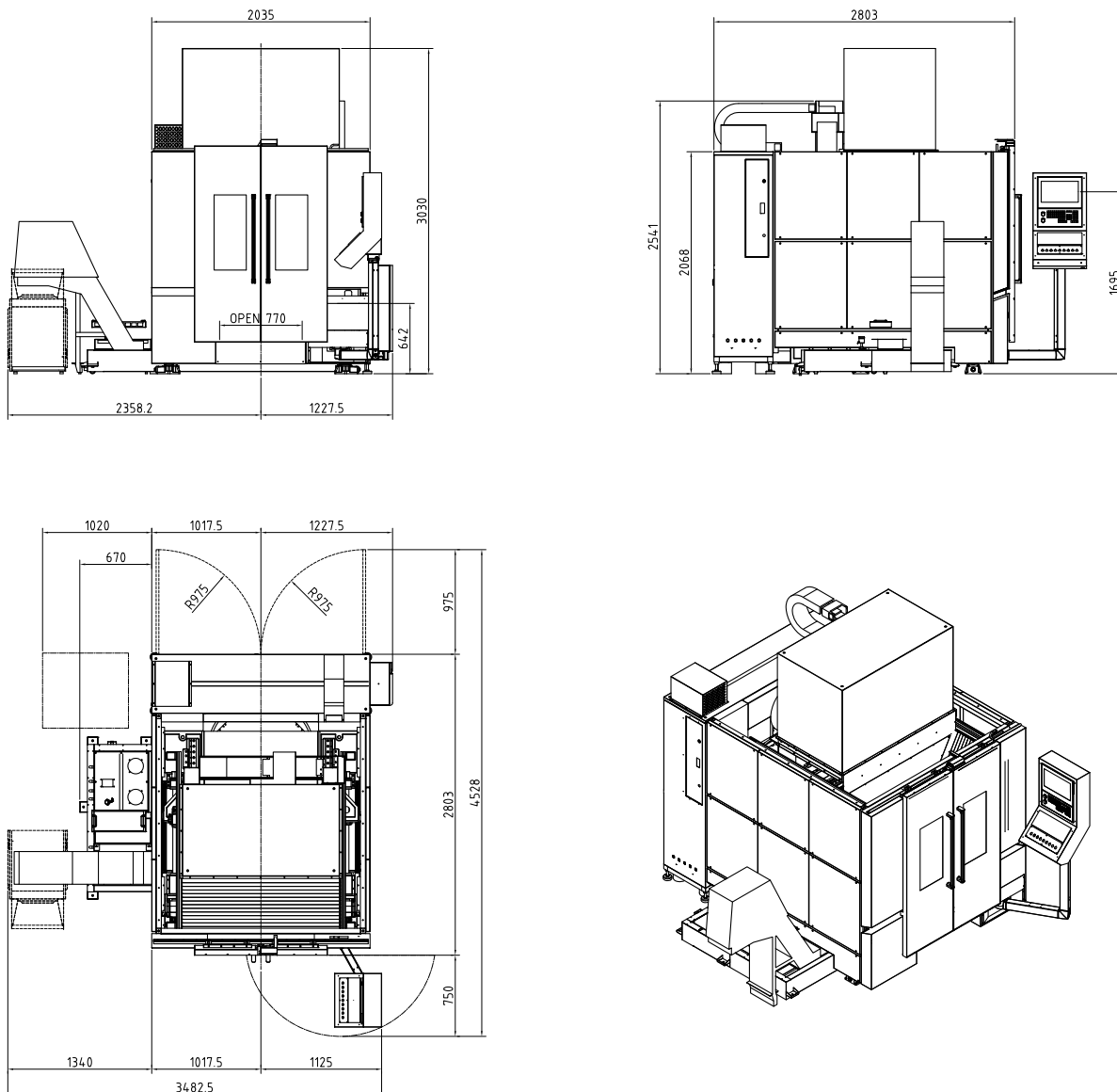

\* The above specifications are subject to change without prior notice, no liability for mistakes. Machines may be shown with optional equipment.

# VF900 · 1100 · 1300 · 1500



- VF series ultra high performance center is specially designed for high speed and high efficiency machining applications
- Advanced design with reinforced body structure through FEM analysis. VF series offers superb cutting performance and reduced vibration to meet the highest machining demands
- Extra wide machine column and base design ensures the high rigidity during high speed movement
- Motor seat cooling circuit (VF1100 & VF1300)
- Coolant through ballscrew for VF1100 & VF1300 & VF1500 (option)
- Linear scales (option)



### Standard configuration:

- ✓ Fully enclosed splash guard
- ✓ Direct drive spindle 12000 rpm
- ✓ 24 pockets arm tool changer
- ✓ Two screw type and one chain type (VF 1100, VF1300, VF1500)
- ✓ Chain type chip conveyor (VF900)
- ✓ Spindle cooling system
- ✓ Air-conditioned electrical cabinet
- ✓ Motor seat cooling circuit (VF1100, VF1300, VF1500)
- ✓ Rigid tapping
- ✓ Ethernet, CF card and USB interface
- ✓ Automatic lubrication system
- ✓ Coolant system
- ✓ LED working lamp
- ✓ End of program light
- ✓ Electronic handwheel (MPG)
- ✓ Tool box
- ✓ Leveling bolts and blocks
- ✓ Coolant gun
- ✓ Air gun
- ✓ Air blast during cutting
- ✓ User Manual

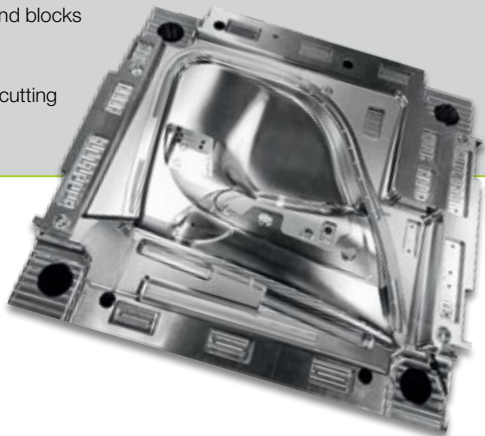

### Optional configuration:

- Direct drive spindle 6000 rpm, BBT50 (VF1100, VF1300, VF1500)
- Direct drive spindle 18000/24000 rpm, BBT40
- Motor spindle 18000 rpm, HSK A63
- CTS coolant through spindle + ATS
- Oil cooled ballscrew
- Oil skimmer
- Linear scales
- 4<sup>th</sup> axis
- 4/5<sup>th</sup> axis
- Workpiece probe
- Tool probe

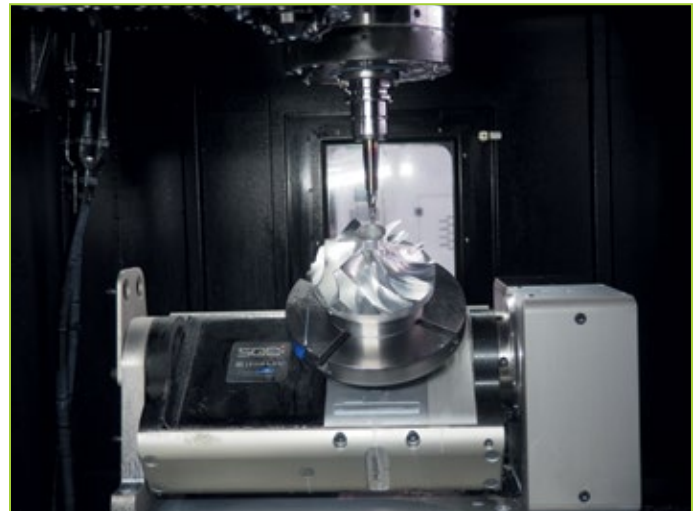

Lehmann 4<sup>th</sup> & 5<sup>th</sup> axis

\* The above specifications are subject to change without prior notice, no liability for mistakes. Machines may be shown with optional equipment.

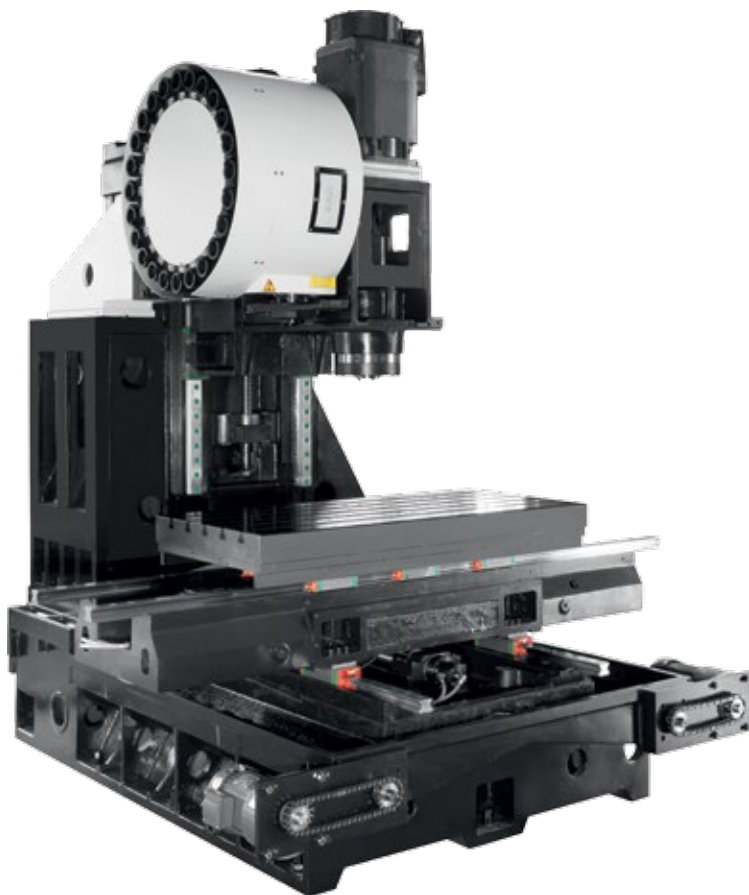

Cast iron tempered for stress relief to ensure structural stability without deformation



Two screw type chip conveyors in Y-axis (VF1100 & VF1300 & VF1500)



External tool cooling

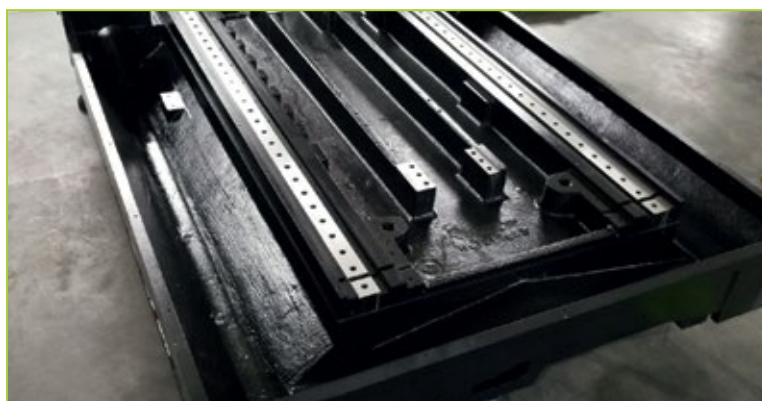

Roller type linear guideway

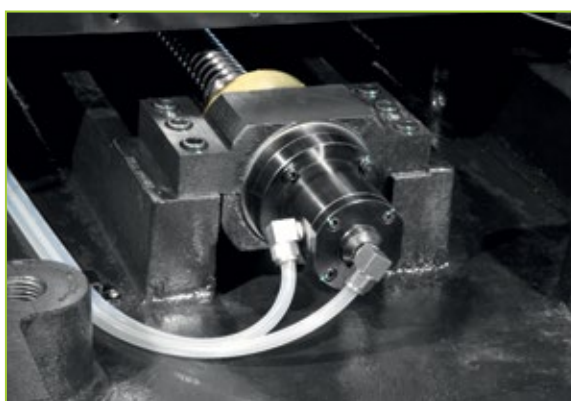

Oil cooled ballscrews (VF1100 & VF1300 & VF1500)

\* The above specifications are subject to change without prior notice, no liability for mistakes. Machines may be shown with optional equipment.

## Worktable (VF1100)

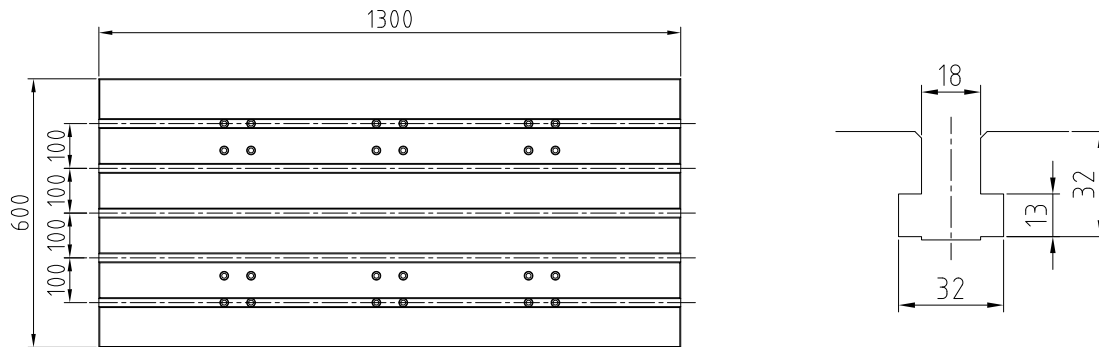

## Dimensions (VF1100)

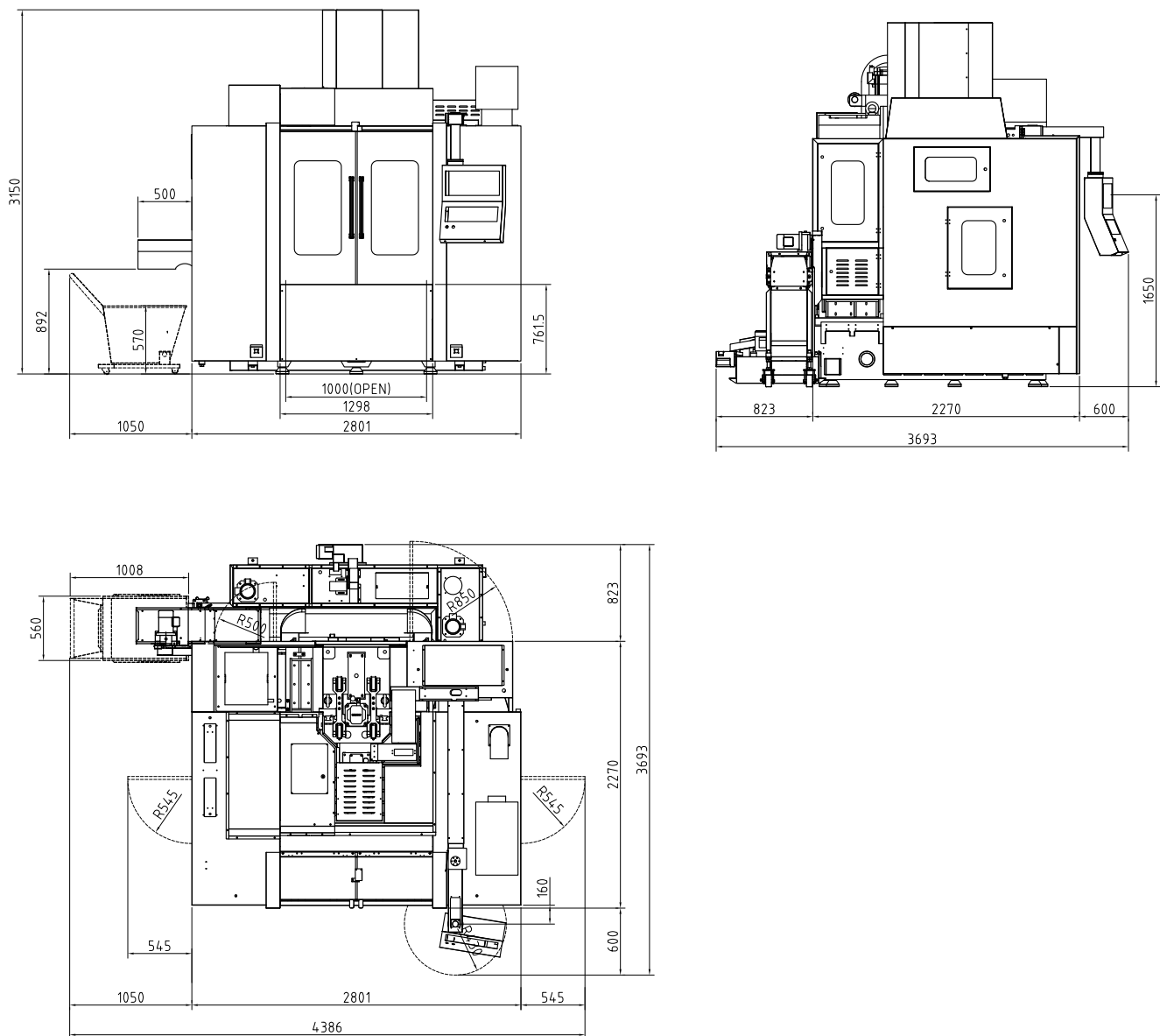

## Technical Specifications

Technical Specifications		VF900	VF1100	VF1300	VF1500
<b>Table</b>					
Table size	mm	1060 x 600	1300 x 600	1500 x 650	1700 x 700
T-slot (width x number x distance)	mm		18 x 5 x 100		18 x 6 x 100
Max. load	kg	650	800	1000	1200
<b>Travel</b>					
X/Y/Z Travel	mm	900 / 600 / 600	1100 / 650 / 600	1300 / 650 / 600	1500/760/700
Spindle nose to table	mm		150 - 750		130 - 830
Spindle center to column	mm	652		697	802
<b>Spindle</b>					
Spindle taper	-		SK40 / BBT40 / CAT 40		
Spindle servo motor	kW	9 / 22 Siemens, 11 / 18.5 Fanuc	20 / 53 Siemens, 15 / 30 Fanuc		
Spindle speed	rpm	12000	15000		
<b>Feed</b>					
Rapid feed X/Y/Z	m/min		36		24
Cutting feed	mm/min		1 - 12000		
<b>Tool changer</b>					
Number of tools	pcs		24		
Max. tool length	mm		300		
Max. tool diameter	mm		78 (125)		
Max. tool weight	kg		8		
<b>Accuracy (VDI 3441)</b>					
Positioning accuracy (without linear encoder)	mm	0.010 / Full travel		0.012 / Full travel	
Positioning repeatability (without Linear encoder)	mm	0.006 / Full travel		0.008 / Full travel	
Positioning accuracy (with linear encoder)	mm	0.006 / Full travel		0.008 / Full travel	
Positioning repeatability (with linear encoder)	mm	0.004 / Full travel		0.006 / Full travel	
<b>Dimensions &amp; Weight</b>					
Dimensions	mm	3850 x 2335 x 3000	3850 x 3093 x 3150	4025 x 3693 x 3250	4025 x 3693 x 3250
Weight	kg	6800	8000	8500	10000



Cooling unit with chip conveyor



Keyarrow telescopic covers in all axes

\* The above specifications are subject to change without prior notice, no liability for mistakes. Machines may be shown with optional equipment.

## VF760



- Cast iron is tempered for stress relief to ensure structural stability without deformation
- C3 class ballscrews ensures the highest accuracy and durability
- Pre-tension on all axis minimizes thermal distortion



### Standard configuration:

- ✓ Fully enclosed splash guard
- ✓ Direct drive spindle 12000 rpm
- ✓ Spindle cooling system
- ✓ 24 pockets arm tool changer
- ✓ Air-conditioned electrical cabinet
- ✓ Rigid tapping
- ✓ Ethernet, CF card and USB interface
- ✓ Automatic lubrication system
- ✓ Coolant system
- ✓ LED working lamp
- ✓ End of program light
- ✓ Electronic handwheel (MPG)
- ✓ Tool box
- ✓ Leveling bolts and blocks
- ✓ Coolant gun
- ✓ Air gun
- ✓ Air blast during cutting
- ✓ Chain type chip conveyor
- ✓ User Manual

### Optional configuration:

- CTS coolant through spindle + ATS
- Motor spindle 20000 rpm, HSK A63
- 4<sup>th</sup> axis
- 4/5<sup>th</sup> axis
- Workpiece probe
- Tool probe
- Linear scales
- Oil skimmer

Technical Specifications		VF760
<b>Table</b>		
Table size	mm	900 x 420
T-slot (width x number x distance)	mm	14 x 3 x 125
Max. load	kg	350
<b>Travel</b>		
X / Y / Z Travel	mm	760 / 450 / 520
Spindle nose to table	mm	100 - 620
Spindle center to column	mm	517
<b>Spindle</b>		
Spindle taper	-	SK 40 / BBT 40 / CAT 40
Spindle servo motor	kW	9 / 22 Siemens; 11 / 18.5 Fanuc
Spindle speed	rpm	12000
<b>Feed</b>		
Rapid feed X/Y/Z	m/min	48 (24 opt.)
Cutting feed	mm/min	1-12000
<b>Tool changer</b>		
Number of tools	pcs	24
Max. tool length	mm	300
Max. tool diameter	mm	78 (125)
Max. tool weight	kg	8
<b>Accuracy (VDI 3441)</b>		
Positioning accuracy (without linear encoder)	mm	0.010 / Full travel
Positioning repeatability (without linear encoder)	mm	0.006 / Full travel
Positioning accuracy (with linear encoder)	mm	0.006 / Full travel
Positioning repeatability (with linear encoder)	mm	0.004 / Full travel
<b>Dimensions &amp; Weight</b>		
Dimensions	mm	3250 x 2710 x 2900
Weight	kg	4500

\* The above specifications are subject to change without prior notice, no liability for mistakes. Machines may be shown with optional equipment.

Worktable

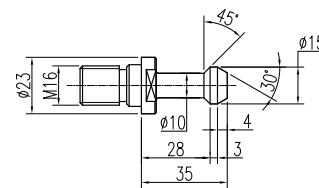
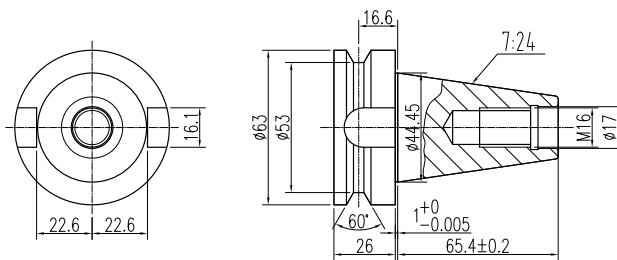
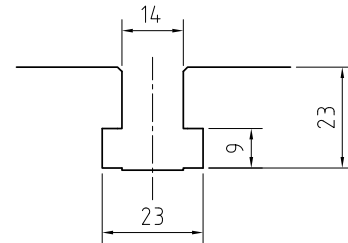
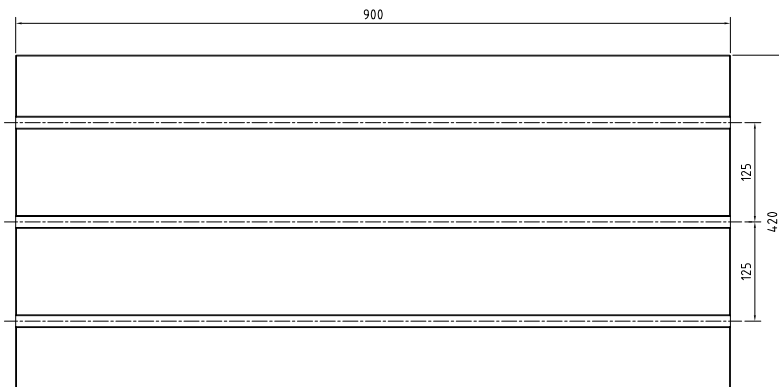

MAS403 BBT40

MAS403P40T-1(45°)

BBT40 tool holder and pull stud (optional SK40)

Dimensions

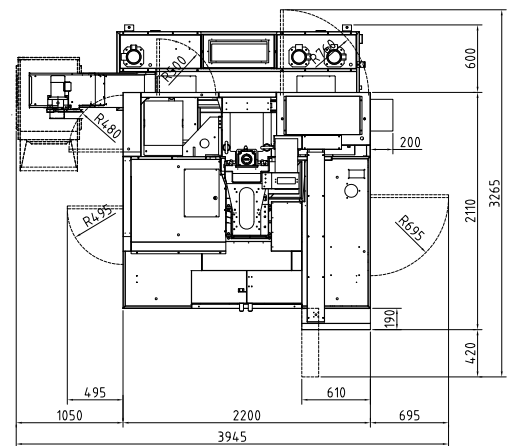
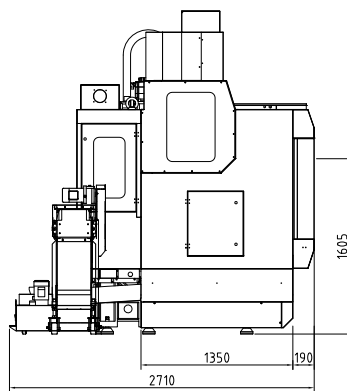
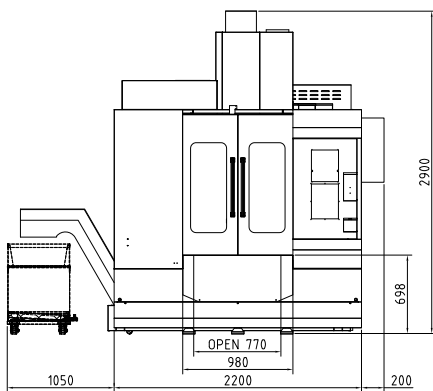

\* The above specifications are subject to change without prior notice, no liability for mistakes. Machines may be shown with optional equipment.

# MINI Center



- Training
- Tool room workshop
- Metal parts machining
- Model making
- R&D
- Cast iron is tempered for stress relief to ensure machine stability without deformation



Technical Specifications		Mini Center
<b>Table</b>		
Table size	mm	650 x 300
T-slot (width x number x distance)	mm	14 x 3 x 100
Max. load	kg	200
<b>Travel</b>		
X / Y / Z Travel	mm	500 / 300 / 400
Spindle nose to table	mm	120 - 520
Spindle center to column	mm	340
<b>Spindle</b>		
Spindle taper	-	SK 40 / BT 40 / CAT 40
Spindle servo motor	kW	4.8 / 19 Siemens; 3.7 / 13 Fanuc
Spindle speed	rpm	10000
<b>Feed</b>		
Rapid speed	m/min	X/Y: 20, Z: 12
Cutting speed	mm/min	1-10000
<b>Tool changer</b>		
Number of tools	pcs	12
Max. tool length	mm	300
Max. tool diameter	mm	90 / 125
Max. tool weight	kg	8
<b>Accuracy (VDI 3441)</b>		
Positioning accuracy	mm	0.012 / Full travel
Positioning repeatability	mm	0.008 / Full travel
<b>Dimensions &amp; Weight</b>		
Dimensions	mm	1660 x 2000 x 2500
Weight	kg	1800

### Standard configuration:

- ✓ Fully enclosed splash guard
- ✓ Belt drive spindle 10000 rpm
- ✓ 12 position umbrella tool changer
- ✓ Heat exchanger for electrical cabinet
- ✓ Rigid tapping
- ✓ Ethernet, CF card and USB interface
- ✓ Automatic lubrication system
- ✓ Coolant system
- ✓ LED working lamp
- ✓ End of program light
- ✓ Electronic handwheel (MPG)
- ✓ Tool box
- ✓ Leveling bolts and blocks
- ✓ Coolant gun
- ✓ Air gun
- ✓ Chip flushing system
- ✓ User Manual

### Optional configuration:

- Spindle cooling system
- Workpiece probe
- Tool probe
- Rotary table
- Oil skimmer





12 station umbrella tool changer



LED Internal lamp



Chip flushing system



4<sup>th</sup> axis optional



Tool probe (optional)



Chip collector & Coolant tank

Worktable

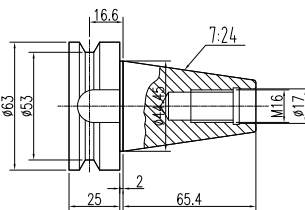
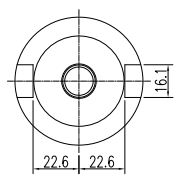
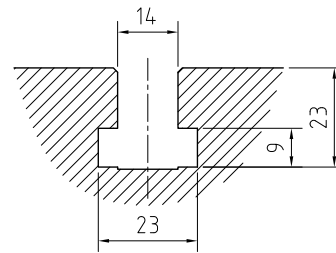
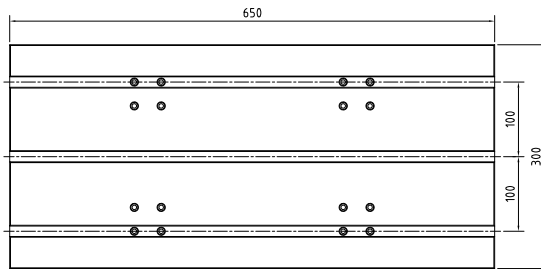

MAS403 BT40

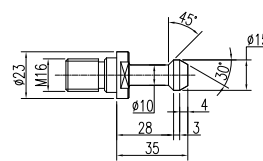

MAS403P40T-1(45°)

BT40 tool holder and pull stud (optional SK40)

Dimensions

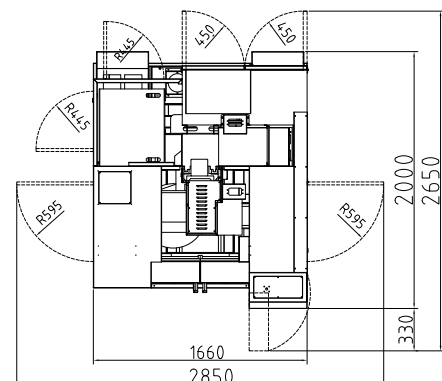
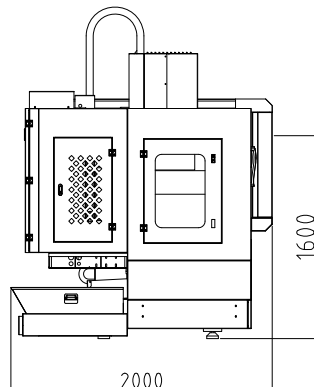
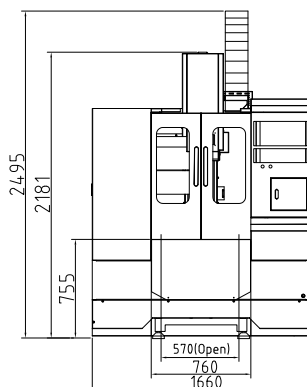

\* The above specifications are subject to change without prior notice, no liability for mistakes. Machines may be shown with optional equipment.

# T7



- Highly rigid machine frame for high acceleration
- High speed and low noise ballscrew and linear guideways on three axes
- Direct drive spindle with standard speed 12000 rpm
- Rapid feed 48 m/min to reduce non-machining time



Technical specifications		T7
<b>Table</b>		
Table	mm	900 x 420
T-slot (width x number x distance)	mm	14 x 3 x 125
Max. load	kg	350
<b>Travel</b>		
X / Y / Z Travel	mm	760 / 450 / 420
Spindle nose to table	mm	150 - 450
Spindle center to column	mm	517
<b>Spindle</b>		
Spindle taper	-	BBT 30
Spindel servo motor	kW	4.8 / 19 Siemens 3.7 / 13 Fanuc
Spindle speed	rpm	12000
<b>Feed</b>		
Rapid feed X/Y/Z	m/min	48
Cutting feed	mm/min	1-12000
<b>Tool changer</b>		
Number of tools	pcs	21
Max. tool length	mm	200
Max. tool diameter	mm	60 (80)
Max. tool weight	kg	2
<b>Accuracy (VDI 3441)</b>		
Positioning accuracy	mm	0.010 / Full travel
Positioning repeatability	mm	0.006 / Full travel
<b>Dimensions &amp; Weight</b>		
Dimensions	mm	2200x2460x2400
Weight	kg	3700

**Standard configuration:**

- ✓ Fully enclosed splash guard
- ✓ Direct drive spindle with 12000 rpm
- ✓ 21 pockets servo type tool changer
- ✓ Heat exchanger for electrical cabinet
- ✓ Rigid tapping
- ✓ Ethernet and CF card and USB interface
- ✓ Automatic lubrication system
- ✓ Coolant system
- ✓ LED working lamp
- ✓ End of program light
- ✓ Spindle cooling system
- ✓ Electronic handwheel (MPG)
- ✓ Tool box
- ✓ Leveling bolts and blocks
- ✓ Coolant gun
- ✓ Air gun
- ✓ Chip flushing system
- ✓ User Manual

**Optional configuration:**

- Spindle speed 20000 rpm
- 4<sup>th</sup> axis
- Workpiece probe
- Tool probe
- CTS Coolant through spindle + ATS
- Oil skimmer

## Worktable

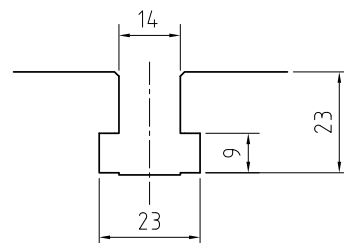
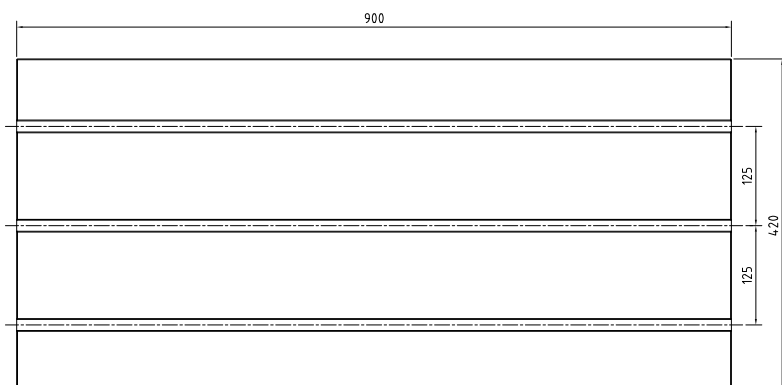

## Dimensions

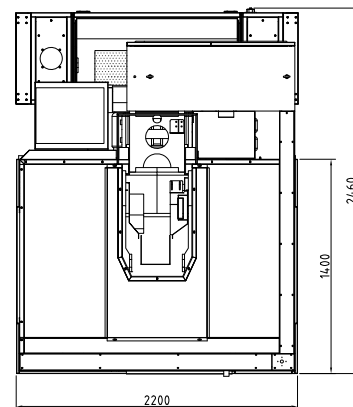
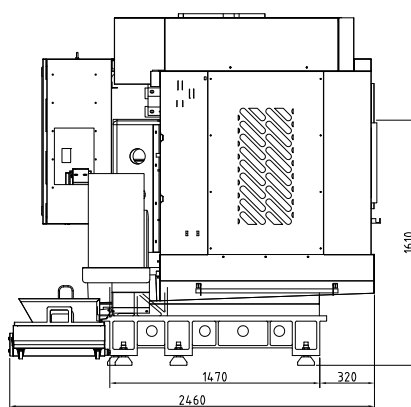
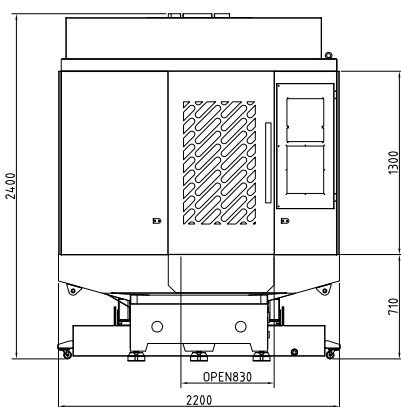

\* The above specifications are subject to change without prior notice, no liability for mistakes. Machines may be shown with optional equipment.

## V6L



- Toolroom workshop
- Metal parts machining
- Mold making, R&D
- Cast iron is tempered for stress relief to ensure machine stability without deformation
- C3 class ballscrews ensures the highest accuracy and durability
- Pre-tension on all axes minimizes thermal distortion



Technical Specifications		Delta Center V6L
<b>Table</b>		
Table size	mm	750 x 400
T-slot (width x number x distance)	mm	14 x 3 x 125
Max. load	kg	350
<b>Travel</b>		
X/Y/Z Travel	mm	600 / 400 / 450
Spindle nose to table	mm	110 - 560
Spindle center to column	mm	434
<b>Spindle</b>		
Spindle taper	-	SK 40 / BT 40 / CAT 40
Spindle speed	rpm	10000
Spindle servo motor	kW	4.8 / 19 Siemens; 3.7 / 13 Fanuc
<b>Feed</b>		
Rapid feed X/Y/Z	m/min	48
Cutting speed	mm/min	1-12000
<b>Tool changer</b>		
Number of tools	pcs	24
Max. tool length	mm	220
Max. tool diameter	mm	78 (125)
Max. tool weight	kg	8
<b>Accuracy (VDI 3441)</b>		
Positioning accuracy	mm	0.010 / Full travel
Positioning repeatability	mm	0.006 / Full travel
<b>Dimensions &amp; Weight</b>		
Dimensions	mm	1800 x 2530 x 2700
Weight	kg	3500

**Standard configuration:**

- ✓ Fully enclosed splash guard
- ✓ Belt drive spindle 10000 rpm
- ✓ 24 pockets arm tool changer
- ✓ Heat exchanger for electrical cabinet
- ✓ Rigid tapping
- ✓ Ethernet CF card and USB interface
- ✓ Automatic lubrication system
- ✓ Coolant system
- ✓ LED working lamp
- ✓ End of program light
- ✓ Electronic handwheel (MPG)
- ✓ Tool box
- ✓ Leveling bolts and blocks
- ✓ Coolant gun
- ✓ Air gun
- ✓ Chip flushing system
- ✓ User Manual

**Optional configuration:**

- Spindle speed 12000 rpm, direct drive
- Spindle cooling system
- CTS Coolant through spindle + ATS
- 4<sup>th</sup> axis
- Workpiece probe
- Tool probe
- Oil skimmer

\* The above specifications are subject to change without prior notice, no liability for mistakes. Machines may be shown with optional equipment.



24 pocket arm tool changer

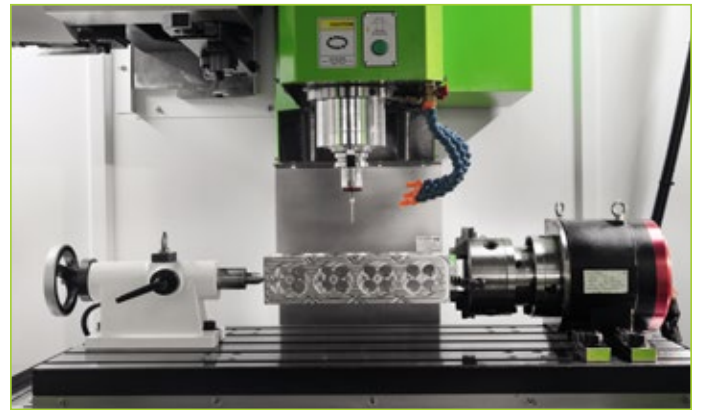

4<sup>th</sup> axis (optional)

Worktable

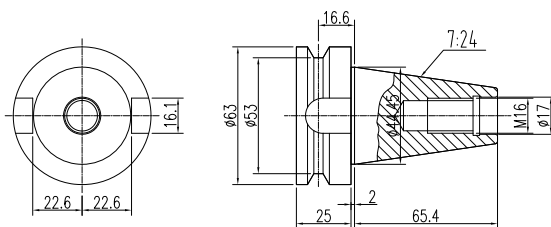
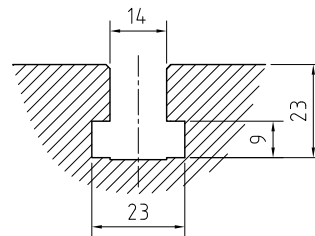
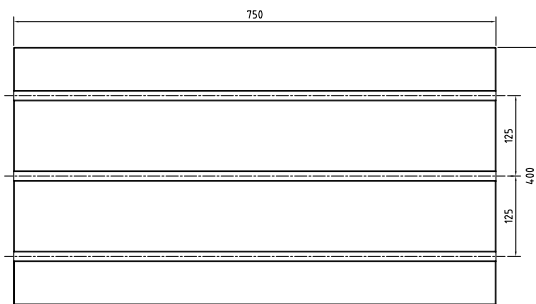

MAS403 BT40

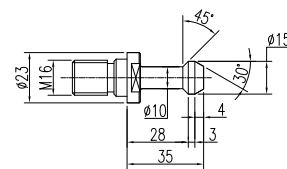

MAS403P40T-1(45°)

BT40 tool holder and pull stud (optional SK40)

Dimensions

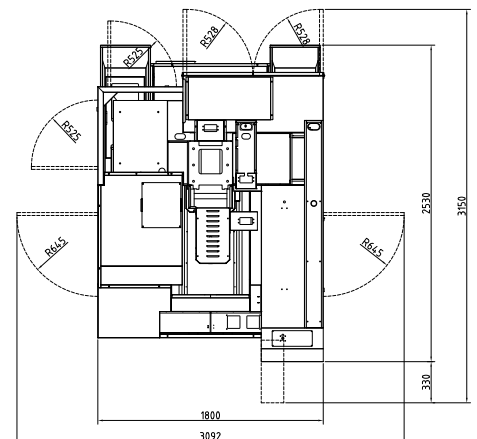
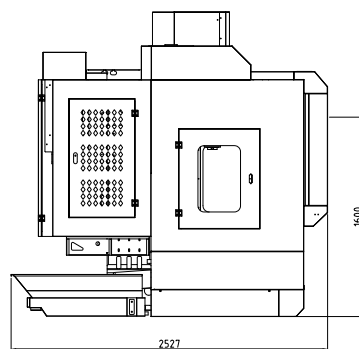
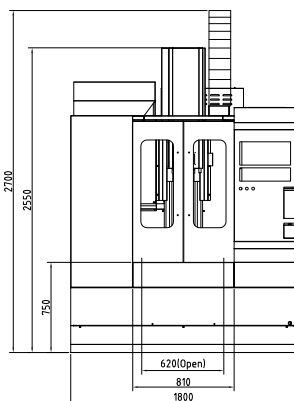

\* The above specifications are subject to change without prior notice, no liability for mistakes. Machines may be shown with optional equipment.

# V10L



- Cast iron is tempered for stress relief to ensure structural stability without deformation
- Pre-tension on all axes minimizes thermal distortion
- C3 class ballscrews ensures the highest accuracy and durability



Technical Specifications		Delta Center V10L
<b>Table</b>		
Table size	mm	1100 x 500
T-slot (width x number x distance)	mm	18 x 5 x 100
Max. load	kg	600
<b>Travel</b>		
X/Y/Z Travel	mm	1020 / 520 / 550
Spindle nose to table	mm	120 - 670
Spindle center to column	mm	566
<b>Spindle</b>		
Spindle taper	-	SK 40 / BT 40 / CAT 40
Spindle speed	rpm	10000
Spindle servo motor	kW	9 / 22 Siemens; 7.5 / 15 Fanuc
<b>Tool changer</b>		
Number of tools	pcs	24
Max. tool diameter	mm	78 (125)
Max. tool length	mm	300
Max. tool weight	kg	8
<b>Feed</b>		
Rapid feed X/Y/Z	m/min	48 (opt. 30)
Cutting speed	mm/min	1-12000
<b>Accuracy (VDI 3441)</b>		
Positioning accuracy	mm	0.010 / Full travel
Positioning repeatability	mm	0.006 / Full travel
<b>Dimensions &amp; Weight</b>		
Dimensions	mm	3870 x 2175 x 2850
Weight	kg	5000

- Standard configuration:**
- ✓ Fully enclosed splash guard
  - ✓ Belt drive spindle 10000 rpm
  - ✓ 24 pockets arm tool changer
  - ✓ Chain type chip conveyor
  - ✓ Air-conditioned electrical cabinet
  - ✓ Rigid tapping
  - ✓ Ethernet, CF card and USB interface
  - ✓ Automatic lubrication system
  - ✓ Coolant system
  - ✓ LED working lamp
  - ✓ End of program light
  - ✓ Electronic handwheel (MPG)
  - ✓ Tool box
  - ✓ Leveling bolts and blocks
  - ✓ Coolant gun
  - ✓ Air gun
  - ✓ Chip flushing system
  - ✓ User Manual

- Optional configuration:**
- Spindle speed 12000 rpm, direct drive
  - Spindle cooling system
  - CTS Coolant through spindle + ATS
  - Oil skimmer
  - Workpiece probe
  - Tool probe
  - 4<sup>th</sup> axis
  - 4/5<sup>th</sup> axis

Worktable

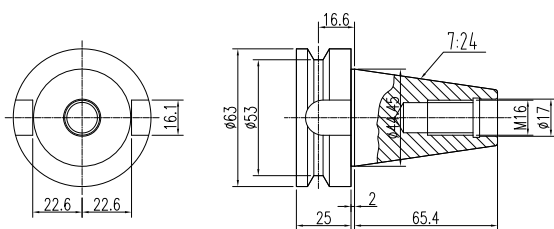
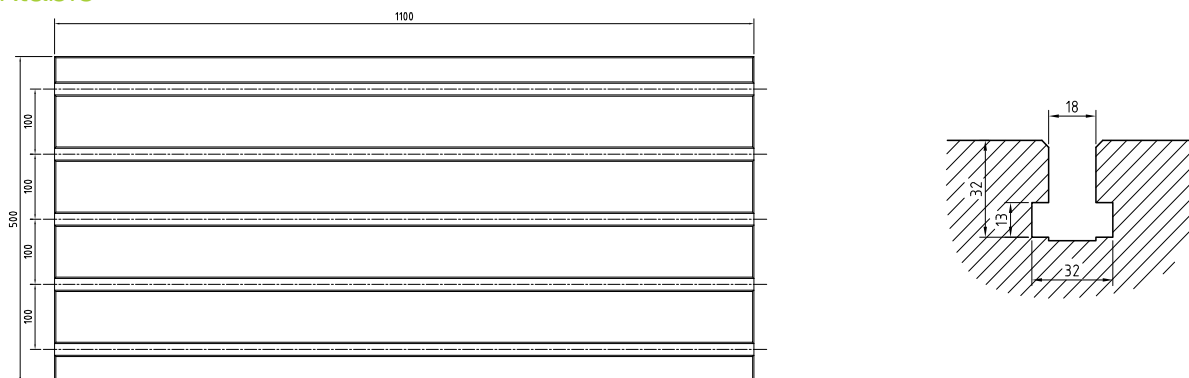

MAS403 BT40

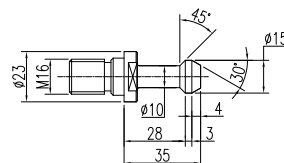

MAS403P40T-1(45°)

BT40 tool holder and pull stud (optional SK40)

Dimensions

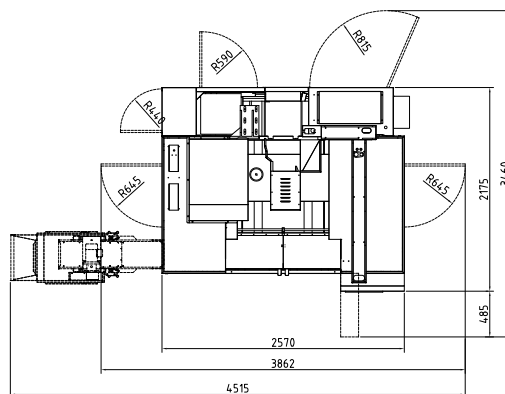
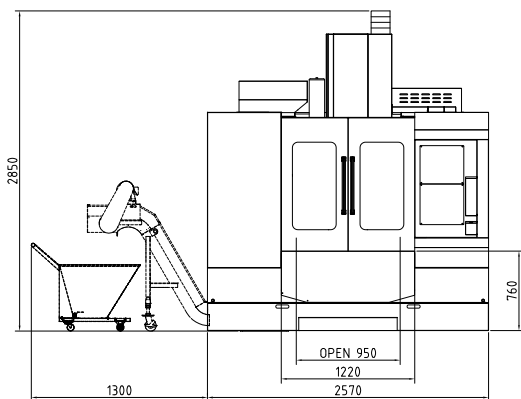

4<sup>th</sup> axis, different sizes

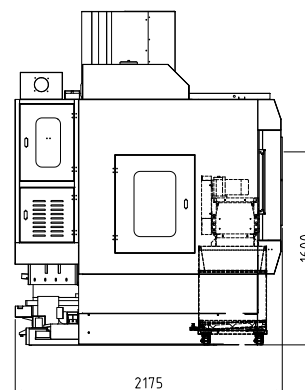

\* The above specifications are subject to change without prior notice, no liability for mistakes. Machines may be shown with optional equipment.

# V7L



Technical Specifications		Alpha Center V7L
<b>Table</b>		
Table size	mm	900 x 420
T-slot (width x number x distance)	mm	14 x 3 x 125
Max. load	kg	350
<b>Travel</b>		
X/Y/Z Travel	mm	760 / 450 / 520
Spindle nose to table	mm	100 - 620
Spindle center to column	mm	517
<b>Spindle</b>		
Spindle taper	-	SK 40 / BT 40 / CAT 40
Spindle speed	rpm	10000
Spindle servo motor	kW	9 / 22 Siemens; 7.5 / 15 Fanuc
<b>Feed</b>		
Rapid feed X/Y/Z	m/min	48
Cutting speed	mm/min	1-12000
<b>Tool changer</b>		
Number of tools	pcs	24
Max. tool length	mm	300
Max. tool diameter	mm	78 (125)
Max. tool weight	kg	8
<b>Accuracy (VDI 3441)</b>		
Positioning accuracy	mm	0.010 / Full travel
Positioning repeatability	mm	0.006 / Full travel
<b>Dimensions &amp; Weight</b>		
Dimensions	mm	3450 x 2710 x 2900
Weight	kg	4500

### Standard configuration:

- ✓ Fully enclosed splash guard
- ✓ Belt drive spindle 10000 rpm
- ✓ 24 pockets arm tool changer
- ✓ Chain type chip conveyor
- ✓ Air-conditioned electrical cabinet
- ✓ Rigid tapping
- ✓ Ethernet CF card and USB interface
- ✓ Automatic lubrication system
- ✓ Coolant system
- ✓ LED working lamp
- ✓ End of program light
- ✓ Electronic handwheel (MPG)
- ✓ Tool box
- ✓ Leveling bolts and blocks
- ✓ Coolant gun
- ✓ Air gun
- ✓ Chip flushing system
- ✓ User Manual

### Optional configuration:

- Spindle speed 12000 rpm, direct drive
- Spindle cooling system
- CTS Coolant through spindle + ATS
- Oil skimmer
- Workpiece probe
- Tool probe
- 4<sup>th</sup> axis
- 4/5<sup>th</sup> axis



Worktable

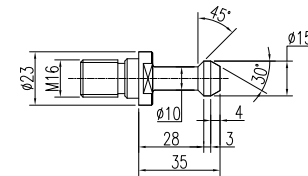
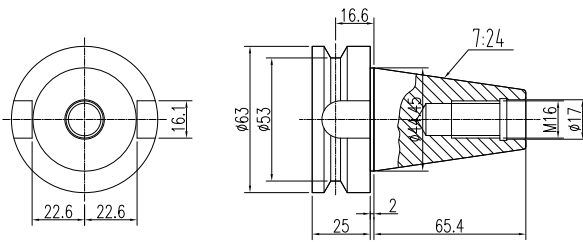
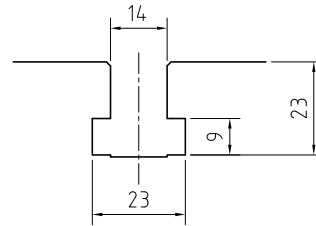
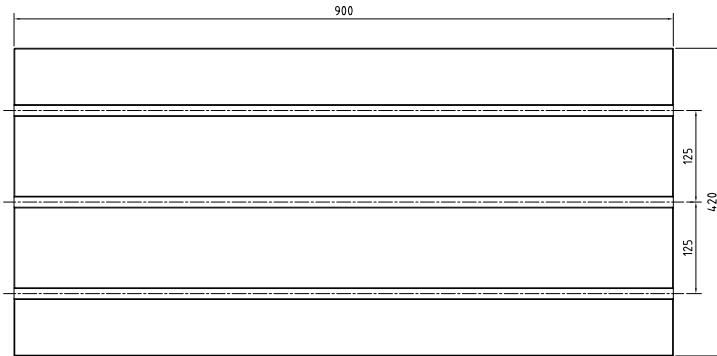

MAS403 BT40

MAS403P40T-1(45°)

BT40 tool holder and pull stud (optional SK40)

Dimensions

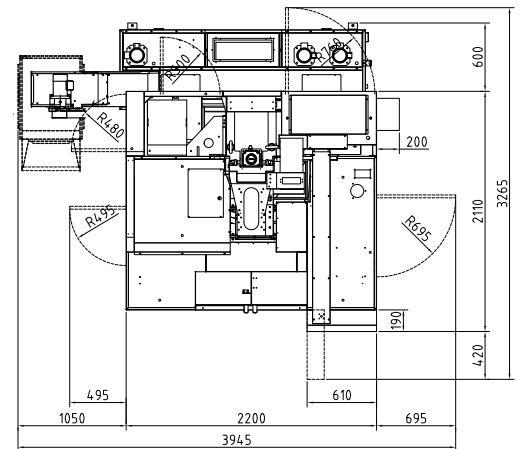
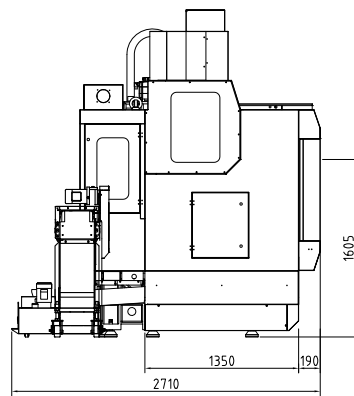
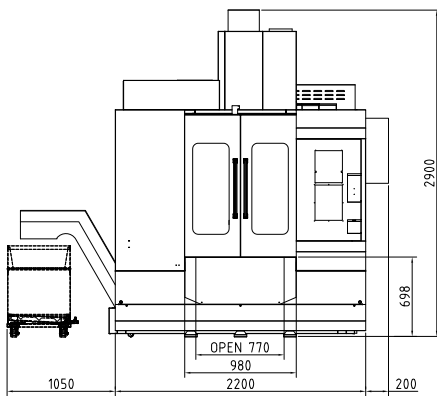

\* The above specifications are subject to change without prior notice, no liability for mistakes. Machines may be shown with optional equipment.

## V9L · V11L



- Cast iron is tempered for stress relief to ensure structural stability without deformation
- C3 class ballscrews ensures the highest accuracy and durability
- Pre-tension on all axis minimizes thermal distortion



Technical Specifications		V9L	V11L
<b>Table</b>			
Table size	mm	1060 x 600	1200 x 600
T-slots (width x number x distance)	mm	18 x 5 x 100	
Max. load	kg	650	800
<b>Travel</b>			
X/Y/Z Travel	mm	900 / 600 / 600	1100 / 600 / 600
Spindle nose to table	mm	150 - 750	
Spindle center to column	mm	652	
<b>Spindle</b>			
Spindle taper	-	SK 40 / BT 40 / CAT 40	
Spindle servo motor	kW	9 / 22 Siemens; 11 / 18.5 Fanuc	
Spindle speed	rpm	10000	
<b>Feed</b>			
Rapid feed X/Y/Z	m/min	36	
Cutting speed	mm/min	1-12000	
<b>Tool changer</b>			
Number of tools	pcs	24	
Max. tool length	mm	300	
Max. tool diameter	mm	78 (125)	
Max. weight	kg	8	
<b>Accuracy (VDI 3441)</b>			
Positioning accuracy	mm	0.010 / Full travel	
Positioning repeatability	mm	0.006 / Full travel	
<b>Dimensions &amp; Weight</b>			
Dimensions	mm	3850 x 2336 x 3000	
Weight	kg	6300	6500

**Standard configuration:**

- ✓ Fully enclosed splash guard
- ✓ Belt drive spindle 10000 rpm
- ✓ 24 pockets arm tool changer
- ✓ Chain type chip conveyor
- ✓ Air-conditioned for electrical cabinet
- ✓ Rigid tapping
- ✓ Ethernet, CF card and USB interface
- ✓ Automatic lubrication system
- ✓ Coolant system
- ✓ LED working lamp
- ✓ End of program light
- ✓ Electronic handwheel (MPG)
- ✓ Tool box
- ✓ Leveling bolts and blocks
- ✓ Coolant gun
- ✓ Air gun
- ✓ Chip flushing system
- ✓ User Manual

**Optional configuration:**

- Spindle speed 12000 rpm, direct drive
- Spindle cooling system
- CTS Coolant through spindle + ATS
- Oil skimmer
- Workpiece probe
- Tool probe
- 4<sup>th</sup> axis
- 4/5<sup>th</sup> axis

Worktable (V11L)

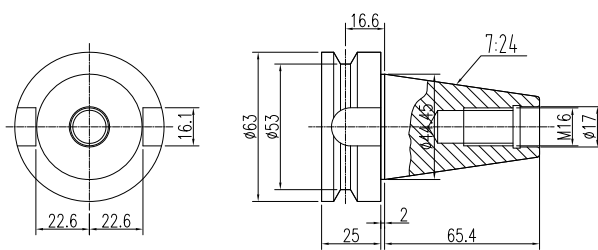
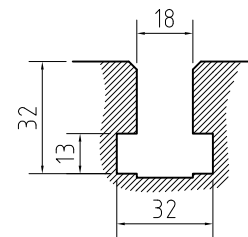
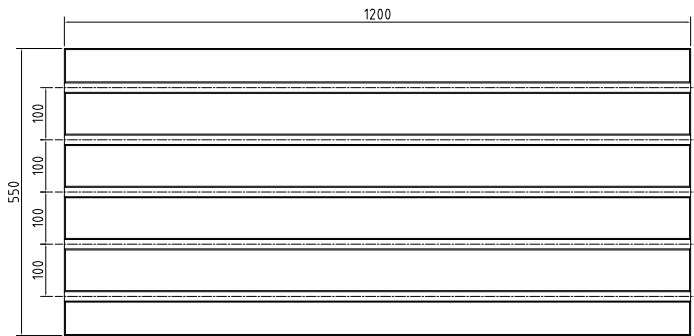

MAS403 BT4

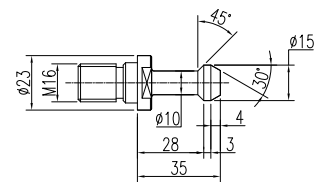

MAS403P40T-1 (45°)

BT40 tool holder and pull stud (optional SK40)

Dimensions (V11L)

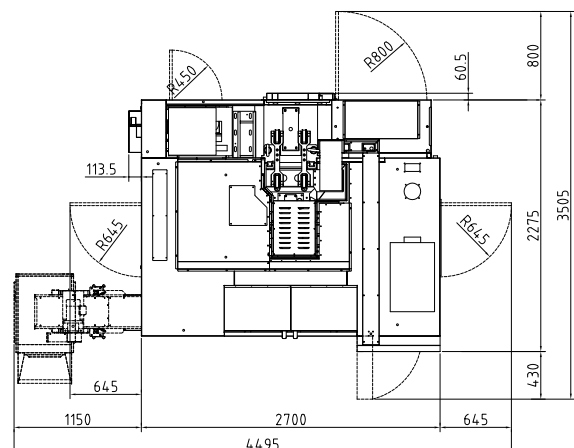
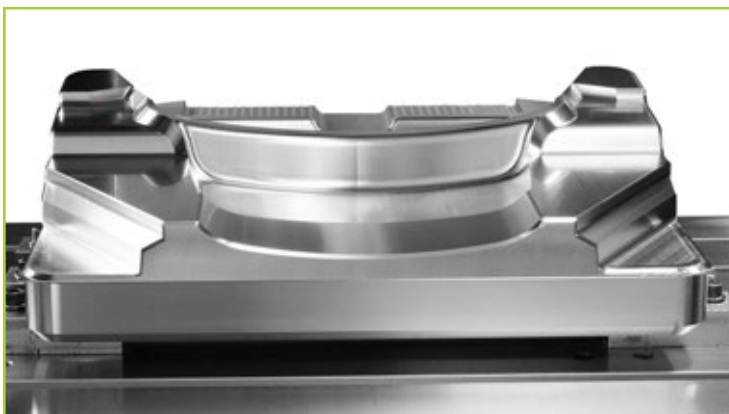
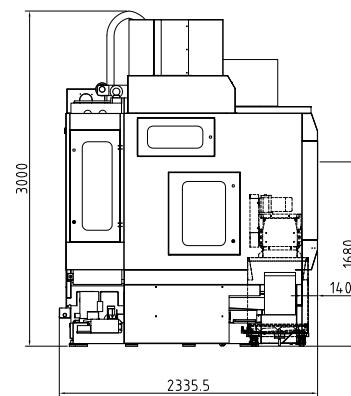
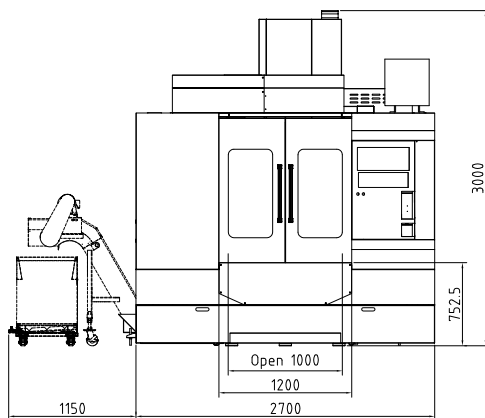

\* The above specifications are subject to change without prior notice, no liability for mistakes. Machines may be shown with optional equipment.

# V13L · V15L



- Cast iron is tempered for stress relief to ensure structural stability without deformation
- C3 class ballscrews ensures the highest accuracy and durability
- Pre-tension on all axis minimizes thermal distortion

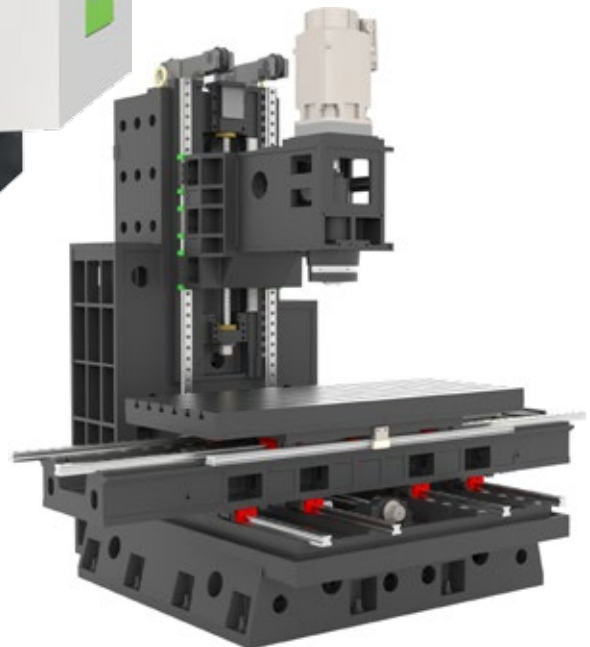

Technical Specifications		V13L	V15L
<b>Table</b>			
Table size	mm	1400 x 600	1700 x 700
T-slot (width x number x distance)	mm	18 x 5 x 100	18 x 6 x 100
Max. load	kg	1000	1500
<b>Travel</b>			
X / Y / Z Travel	mm	1300 / 760 / 670	1500 / 760 / 700
Spindle nose to table	mm	100 - 770	130 - 830
Spindle center to column	mm	797	802
<b>Spindle</b>			
Spindle taper	-	SK 40 / BT 40 / CAT 40	
Spindle speed	rpm	10000	
Spindle servo motor	kW	15 / 38 Siemens; 11 / 18.5 Fanuc	
<b>Tool changer</b>			
Number of tools	pcs	24	
Max. tool length	mm	300	
Max. tool diameter	mm	78 (125)	
Max. tool weight	kg	8	
<b>Feed</b>			
Rapid feed X/Y/Z	m/min	24	
Cutting speed	mm/min	1-12000	
<b>Accuracy (VDI 3441)</b>			
Positioning accuracy	mm	0.012 / Full travel	
Positioning repeatability	mm	0.008 / Full travel	
<b>Dimensions &amp; Weight</b>			
Dimensions	mm	5000 x 2432 x 3100	
Weight	kg	8000	10000

### Standard configuration:

- ✓ Fully enclosed splash guard
- ✓ Belt drive spindle 10000 rpm
- ✓ 24 pockets arm tool changer
- ✓ Chain type chip conveyor
- ✓ Air-conditioned electrical cabinet
- ✓ Rigid tapping
- ✓ Ethernet, CF card and USB interface
- ✓ Automatic lubrication system
- ✓ Coolant system
- ✓ LED working lamp
- ✓ End of program light
- ✓ Electronic handwheel (MPG)
- ✓ Tool box
- ✓ Leveling bolts and blocks
- ✓ Coolant gun
- ✓ Air gun
- ✓ Air blast during cutting
- ✓ User Manual

### Optional configuration:

- Belt drive spindle 6000 rpm BT50
- Spindle speed 12000 rpm, direct drive
- Spindle cooling system
- CTS Coolant through spindle + ATS
- Oil skimmer
- Workpiece probe
- Tool probe
- 4<sup>th</sup> axis
- 4/5<sup>th</sup> axis

\* The above specifications are subject to change without prior notice, no liability for mistakes. Machines may be shown with optional equipment.

Worktable (V15L)

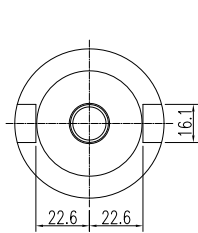
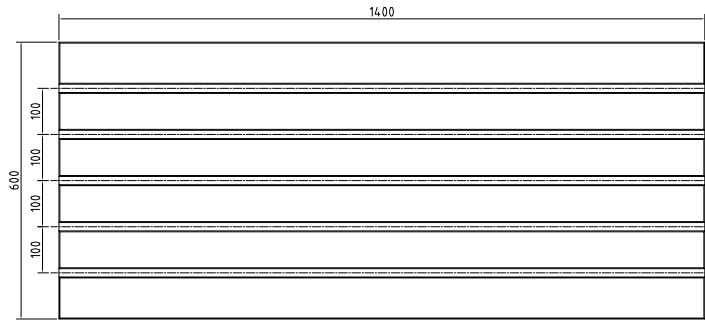

MAS403 BT40

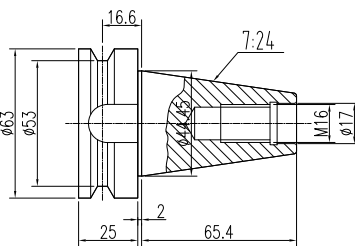

BT40 tool holder and pull stud (optional SK40)

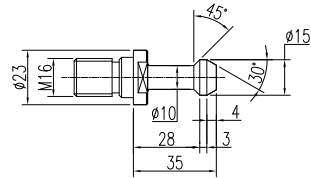
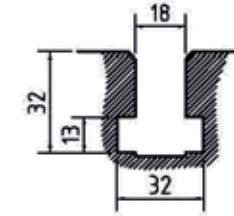

MAS403P40T-1 (45°)

Dimensions (V15L)

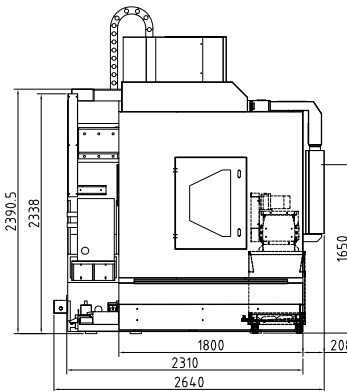
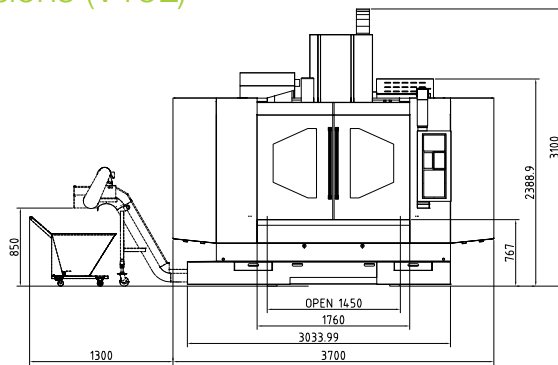

5<sup>th</sup> axis, different sizes

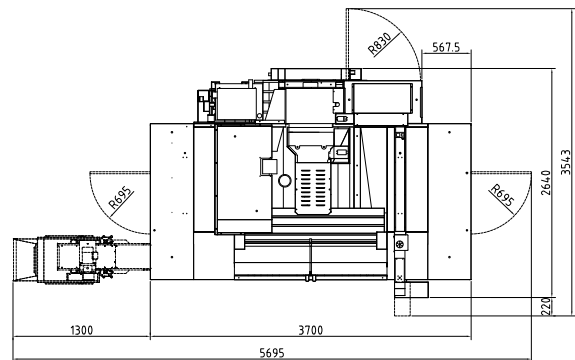

\* The above specifications are subject to change without prior notice, no liability for mistakes. Machines may be shown with optional equipment.

# V18

- Best choice for super heavy duty cutting with large workpiece
- X and Y axis with roller type linear guideways and Z axis with boxway guideways
- 50 taper spindle with belt drive 6000 rpm as standard, and optional with gearbox



- C3 class ballscrews ensures the highest accuracy and durability
- Pre-tension on all axis minimizes thermal distortion

Technical Specifications		Power Center V18
<b>Table</b>		
Table size	mm	1900 x 900
T-slot (width x number x distance)	mm	18 x 7 x 120
Max. load	kg	2000
<b>Travel</b>		
X / Y / Z Travel	mm	1800 / 900 / 700
Spindle nose to table	mm	200 - 900
Spindle center to column	mm	1000
<b>Spindle</b>		
Spindle taper	-	SK 50 / BT 50 / CAT 50
Spindle servo motor	kW	22 / 60 Siemens 22 / 26 Fanuc
Spindle speed	rpm	6000
<b>Feed</b>		
Rapid speed X/Y/Z	m/min	24/24/15
Cutting speed	mm/min	1-12000
<b>Tool changer</b>		
Number of tools	pcs	24
Max. tool length	mm	400
Max. tool diameter	mm	125 / 245 (next release)
Max. tool weight	kg	15
<b>Accuracy (VDI 3441)</b>		
Positioning accuracy	mm	0.020 / Full travel
Positioning repeatability	mm	0.010 / Full travel
<b>Dimensions &amp; Weight</b>		
Dimensions	mm	6060 x 3270 x 3650
Weight	kg	17500

### Standard configuration:

- ✓ Fully enclosed splash guard
- ✓ Belt drive spindle 6000 rpm
- ✓ 24 pockets arm tool changer
- ✓ Chain type chip conveyor
- ✓ Chip conveyor (4 screw type and 1 chain type)
- ✓ Air-conditioned electrical cabinet
- ✓ Rigid tapping
- ✓ Ethernet, CF card and USB interface
- ✓ Automatic lubrication system
- ✓ Coolant system
- ✓ LED working lamp
- ✓ End of program light
- ✓ Electronic handwheel (MPG)
- ✓ Tool box
- ✓ Leveling bolts and blocks
- ✓ Coolant gun
- ✓ Air gun
- ✓ Air blast during cutting
- ✓ User Manual

### Optional configuration:

- Spindle cooling system
- Gear box spindle 6000 rpm with transmission ratio 1:4
- CTS Coolant through spindle + ATS
- Oil skimmer
- Workpiece probe
- Tool probe
- 4<sup>th</sup> axis
- 4/5<sup>th</sup> axis

Worktable



Dimensions

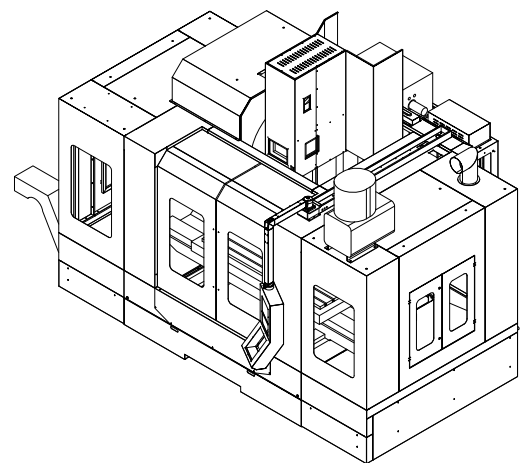
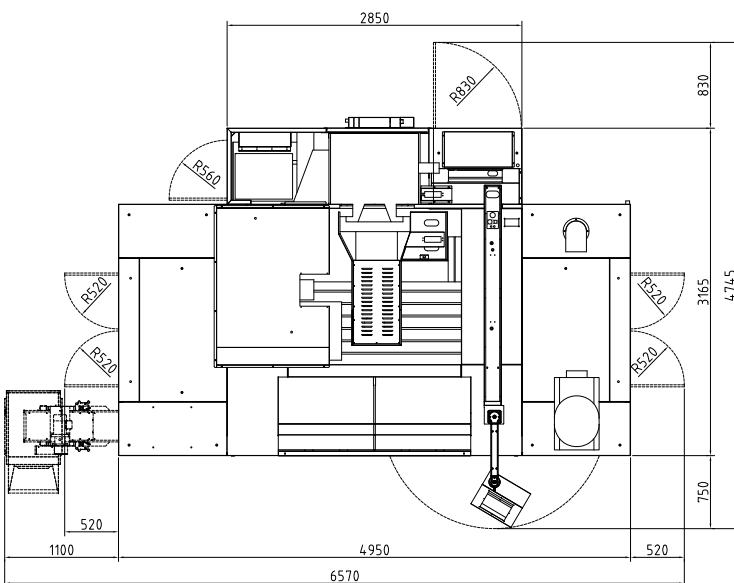
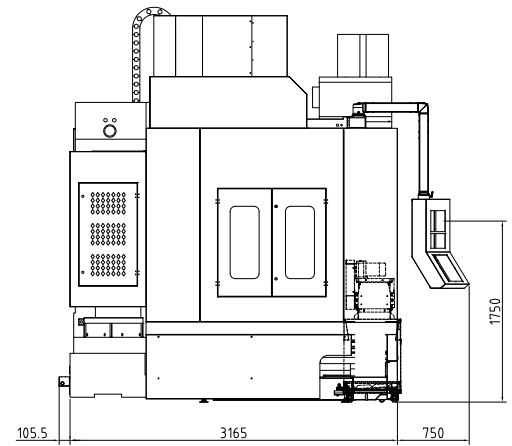
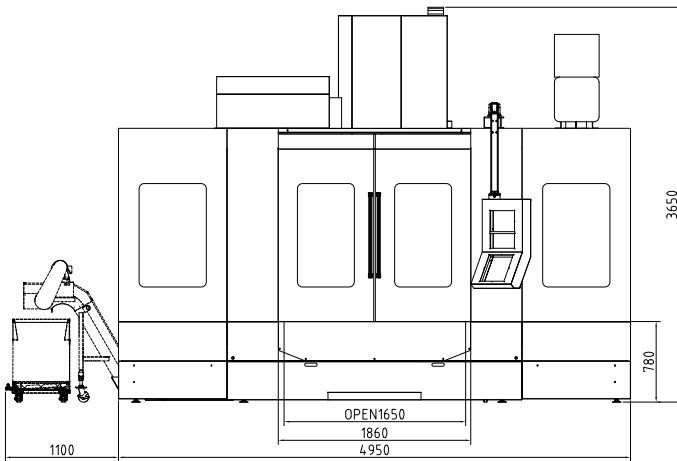

\* The above specifications are subject to change without prior notice, no liability for mistakes. Machines may be shown with optional equipment.

# V1613HS · V2013HS

- Cast iron is tempered for stress relief to ensure structural stability without deformation
- C3 class ballscrews ensures the highest accuracy and durability
- Pre-tension on all axes minimizes thermal distortion
- Roller type linear guideway, which offers super high rigidity and loading capacity



### Standard configuration:

- ✓ Fully enclosed splash guard
- ✓ Air-conditioned electrical cabinet
- ✓ Rigid tapping
- ✓ Chain type chip conveyor
- ✓ Ethernet, CF card and USB interface
- ✓ Automatic lubrication system
- ✓ Coolant system
- ✓ Spindle cooling system
- ✓ LED working lamp
- ✓ End of program light
- ✓ Electronic handwheel (MPG)
- ✓ Tool box
- ✓ Leveling bolts and blots
- ✓ Coolant gun
- ✓ Air gun
- ✓ User Manual

### Optional configuration:

- Direct drive spindle 15000 rpm
- Motor spindle 20000 rpm, HSK A63
- 32 pockets arm tool changer
- Chip conveyor (two screw type and one chain type)
- CTS coolant through spindle +ATS
- Linear scales
- Oil skimmer

Technical Specifications		V1613HS	V2013HS
<b>Table</b>			
Table size	mm	1700 x 1200	2100 x 1200
T-slot (width x number x distance)	mm	18 x 7 x 150	
Max. load	kg	3.000	4.000
<b>Travel</b>			
X/Y/Z Travel	mm	1600 / 1300 / 600	2000 / 1300 / 600
Spindle nose to table	mm	200 - 800	
Distance between columns	mm	1380	
<b>Spindle</b>			
Spindle taper	-	SK40 / BT40 / CAT40	
Spindle servo motor	kW	9/22 Siemens; 11/18.5 Fanuc	
Spindle speed	rpm	12000	
Spindle transmission	-	direct drive	

Technical Specifications		V1613HS	V2013HS
<b>Feed</b>			
Rapid feed X/Y/Z	m/min	20	20
Cutting speed	mm/min	1-12000	1-10000
<b>Tool changer</b>			
Number of tools	pcs	32 (option)	
Max. tool length	mm	300	
Max. tool diameter	mm	78 (125)	
Max. tool weight	kg	8	
<b>Accuracy</b>			
Positioning accuracy	mm	0.015 / Full travel	
Positioning repeatability	mm	0.012 / Full travel	
<b>Dimensions &amp; Weight</b>			
Dimensions	mm	5881x4110x3650	7090x5010x4250
Weight	kg	15000	16000



Worktable

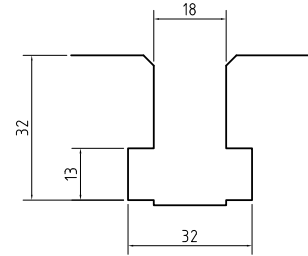
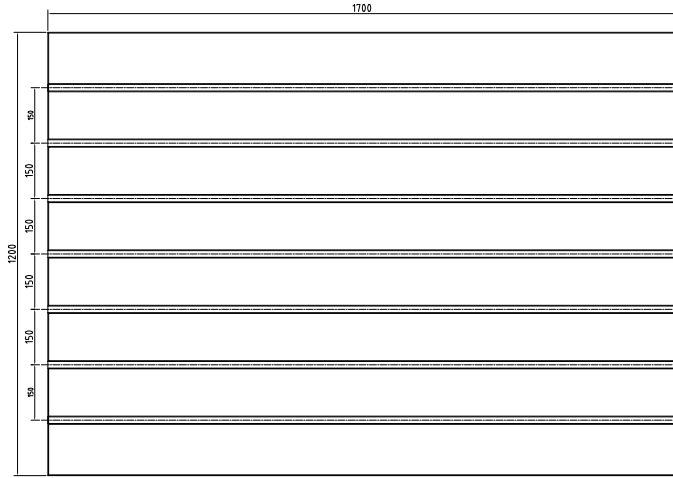

Dimensions (V1613HS)

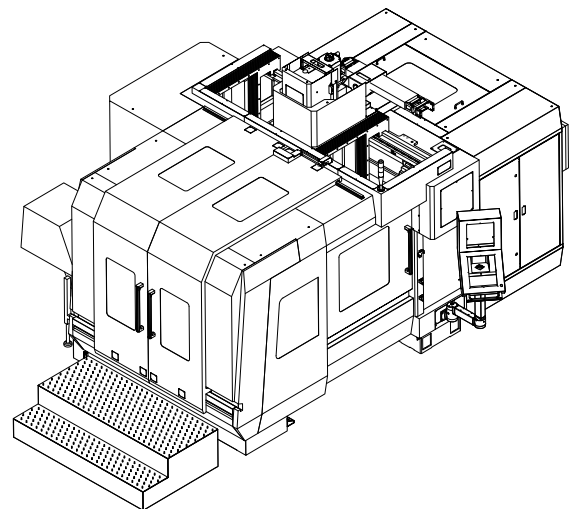
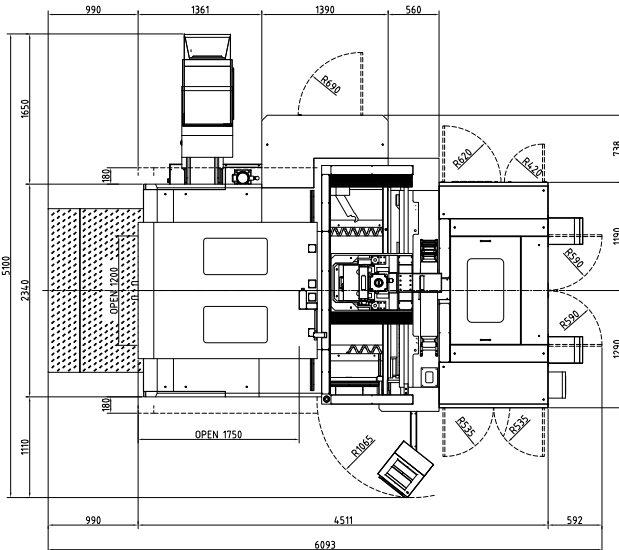
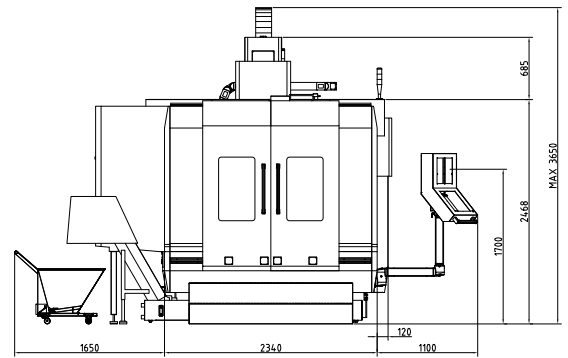
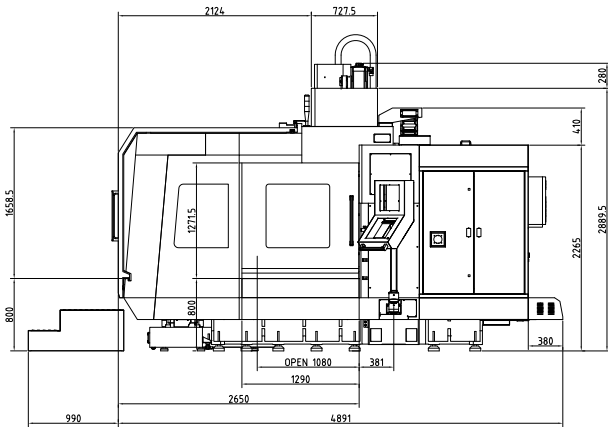

\* The above specifications are subject to change without prior notice, no liability for mistakes. Machines may be shown with optional equipment.

# V2013

- Best choice for super heavy duty cutting with large workpiece
- X and Y axis with roller type linear guideways and Z axis with boxway guideways
- 50 taper spindle with belt drive 6000 rpm as standard, and optional with gearbox



Technical Specifications		V2013
<b>Table</b>		
Table size	mm	2100 x 1200
T-slot (width x number x distance)	mm	18 x 7 x 150
Max. load	kg	4.000
<b>Travel</b>		
X/Y/Z Travel	mm	2000 / 1300 / 800
Spindle nose to table	mm	200 - 1000
Distance between columns	mm	1380
<b>Spindle</b>		
Spindle taper	-	SK50 / BT50 / CAT50
Spindle servo motor	kW	22/60 Siemens; 15/18.5 Fanuc
Spindle speed	rpm	6000
Spindle transmission	-	belt drive
<b>Feed</b>		
Rapid feed X/Y/Z	m/min	15 / 15 / 12
Cutting speed	mm/min	1 - 10000
<b>Tool changer</b>		
Number of tools	pcs	24 (option)
Max. tool length	mm	400
Max. tool diameter	mm	120/250 (next release)
Max. tool weight	kg	15
<b>Accuracy (VDI 3441)</b>		
Positioning accuracy	mm	0.015 / Full travel
Positioning repeatability	mm	0.012 / Full travel
<b>Dimensions &amp; Weight</b>		
Dimensions	mm	7090 x 4120 x 4250
Weight	kg	18000

### Standard configuration:

- ✓ Fully enclosed splash guard
- ✓ Air-conditioned electrical cabinet
- ✓ Rigid tapping
- ✓ Chain type chip conveyor
- ✓ Ethernet, CF card and USB interface
- ✓ Automatic lubrication system
- ✓ Coolant system
- ✓ Spindle cooling system
- ✓ LED working lamp
- ✓ End of program light
- ✓ Electronic handwheel (MPG)
- ✓ Tool box
- ✓ Leveling bolts and blocks
- ✓ Coolant gun
- ✓ Air gun
- ✓ User Manual

### Optional configuration:

- 24 pockets arm tool changer
- 40 pockets chain type tool changer
- Chip conveyor (two screw type and one chain type)
- CTS coolant through spindle +ATS
- Manual 90 degree milling head
- Gear box
- Linear scales

Worktable

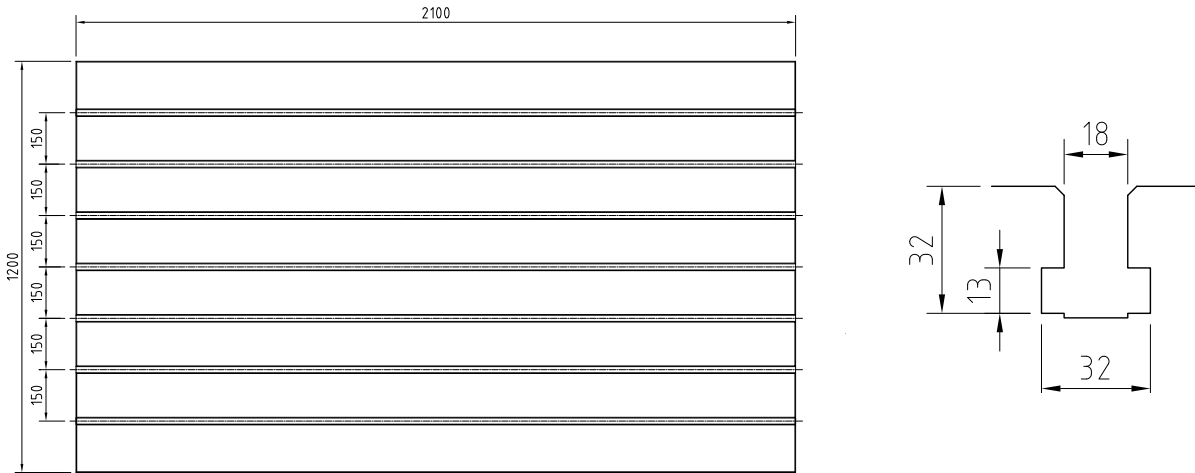

Dimensions

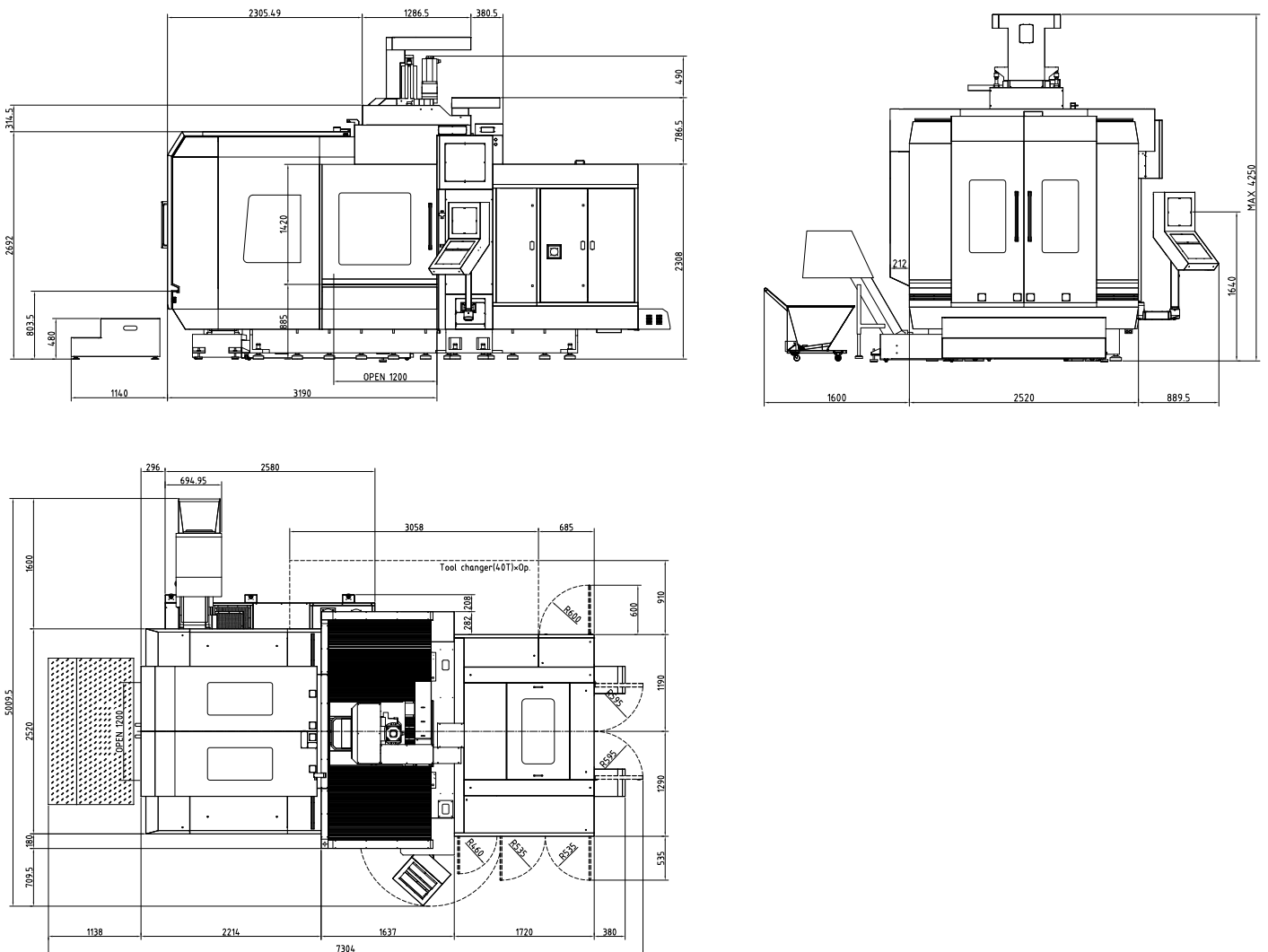

\* The above specifications are subject to change without prior notice, no liability for mistakes. Machines may be shown with optional equipment.

# V2317 · V3317 · V3025 · V4025



### Standard configuration:

- ✓ Half enclosed splash guard
- ✓ Air-conditioned electrical cabinet
- ✓ Rigid tapping
- ✓ Chain type chip conveyor
- ✓ Ethernet, CF card and USB interface
- ✓ Automatic lubrication system
- ✓ Coolant system
- ✓ Spindle cooling system
- ✓ LED working lamp
- ✓ End of program light
- ✓ Electronic handwheel (MPG)
- ✓ Tool box
- ✓ Leveling bolts and blocks
- ✓ Coolant gun
- ✓ Air gun
- ✓ User Manual

### Optional configuration:

- 24 pockets arm tool changer
- 40 pockets chain type tool changer
- Chip conveyor (two screw type and one chain type)
- CTS coolant through spindle +ATS
- Manual 90 degree milling head
- Gear box
- Linear scales

Technical Specifications		V2317	V3317
<b>Table</b>			
Table size	mm	2300 x 1500	3300 x 1500
T-slot (width x number x distance)	mm	22 x 8 x 170	
Max. load	kg	8000	10000
<b>Travel</b>			
X/Y/Z Travel	mm	2300 / 1600 / 800	3300 / 1600 / 800
Spindle nose to table	mm	240 - 1040	
Distance between columns	mm	1680	
<b>Spindle</b>			
Spindle taper	-	SK50 / BT50 / CAT 50	
Spindle servo motor	kW	22 / 60 Siemens, 22 / 45 Fanuc	
Spindle speed	rpm	6000	
Spindle transmission		belt drive	

Technical Specifications		V2317	V3317
<b>Feed</b>			
Rapid feed X/Y/Z	m/min	15 / 15 / 12	
Cutting speed	mm/min	1-10000	
<b>Tool changer</b>			
Number of tools	pcs	24 (option)	
Max. tool length	mm	400	
Max. tool diameter	mm	120 / 250 (next release)	
Max. tool weight	kg	15	
<b>Accuracy (VDI 3441)</b>			
Positioning accuracy	mm	0.016 / Full travel	0.019 / Full travel
Positioning repeatability	mm	0.013 / Full travel	0.015 / Full travel
<b>Dimensions &amp; Weight</b>			
Dimensions	mm	6700x4700x4550	8700x4700x4550
Weight	kg	24000	26000

- Extra wide column to increase to connection surface with the crossbeam to avoid vibration during cutting
- All axes are moved by high quality precision gear box to ensure high torque and rigidity during movement (V2317 and V3317 on all axes and V3025 / V4025 on X axis)
- Roller type linear guideway, which offers super high rigidity and loading capacity
- Hydraulic balancing system on Z axis



Hydraulic balancing system in Z axis



Gear drive in X axis



Chip conveyor

Technical Specifications	V3025	V4025
<b>Table</b>		
Table size	mm 3000 x 2100	4000 x 2100
T-slot (width x number x distance)	mm 28 x 9 x 220	
Max. load	kg 8000	10000
<b>Travel</b>		
X/Y/Z Travel	mm 3000 / 2500 / 1000	4000 / 2500 / 1000
Spindle nose to table	mm 105 - 1105	
Distance between columns	mm 2480	
<b>Spindle</b>		
Spindle taper	- SK50 / BT50 / CAT 50	
Spindle servo motor	kW 22 / 60 Siemens, 22 / 45 Fanuc	
Spindle speed	rpm 6000	
Spindle transmission	belt drive	

Technical Specifications	V3025	V4025
<b>Feed</b>		
Rapid feed X/Y/Z	m/min 12 / 12 / 10	10 / 12 / 10
Cutting speed	mm/min	1-10000
<b>Tool changer</b>		
Number of tools	pcs 24 (option)	
Max. tool length	mm 400	
Max. tool diameter	mm 120 / 250 (next release)	
Max. tool weight	kg 15	
<b>Accuracy (VDI 3441)</b>		
Positioning accuracy	mm 0.018 / Full travel	0.025 / Full travel
Positioning repeatability	mm 0.015 / Full travel	0.020 / Full travel
<b>Dimensions &amp; Weight</b>		
Dimensions	mm 7800x5300x4950	9800x5300x4950
Weight	kg 29000	33000

\* The above specifications are subject to change without prior notice, no liability for mistakes. Machines may be shown with optional equipment.

## Torque diagram / Standard Siemens

VF1100 · 1300 · 1500 / Alpha Center V13L · V15L

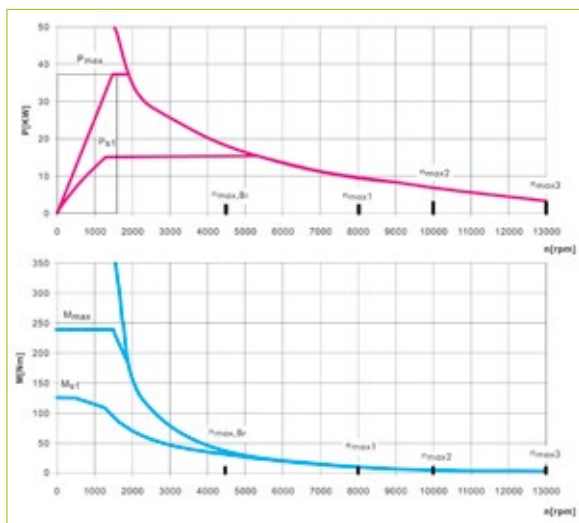

Mini Center / Delta Center V6L · T7

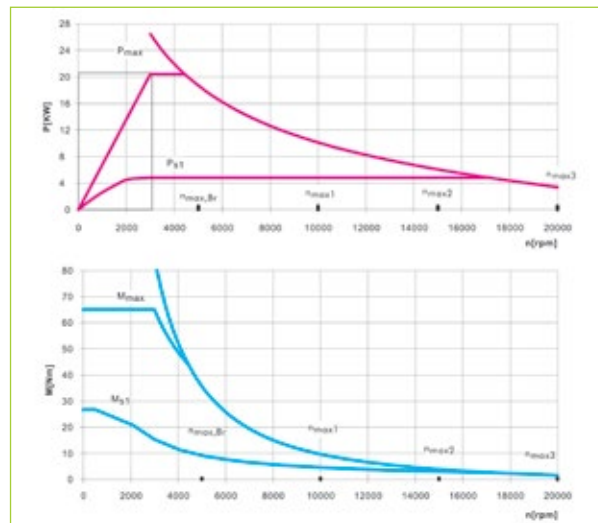

VF760 · 900 / Delta Center V10L / Alpha Center V7L · V9L · V11L

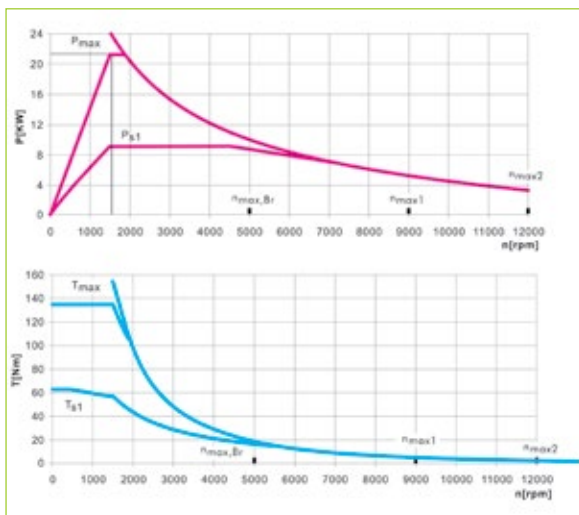

Double Column Center V2013 · V2317 · V3317 · V3025 · V4025 / V18

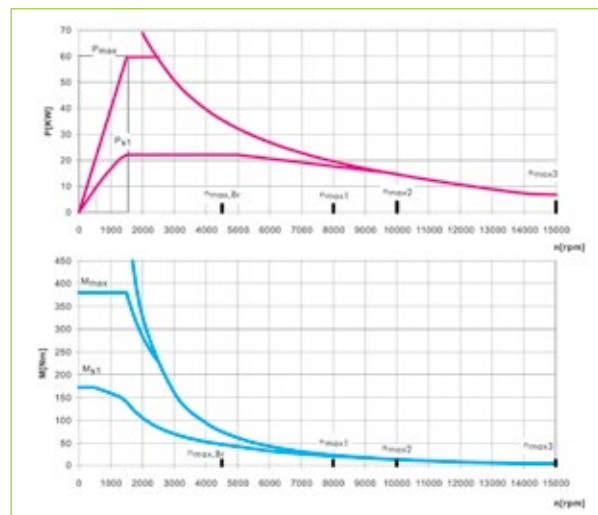

VF760 · 20000 rpm · HSK A63

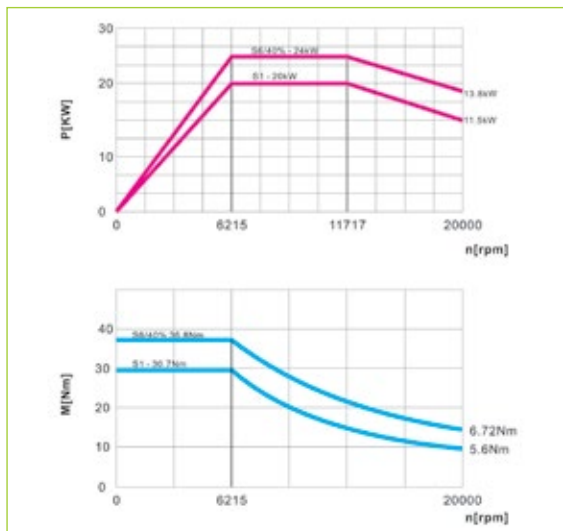

High Speed Double Column Center V1613HS · V2013HS

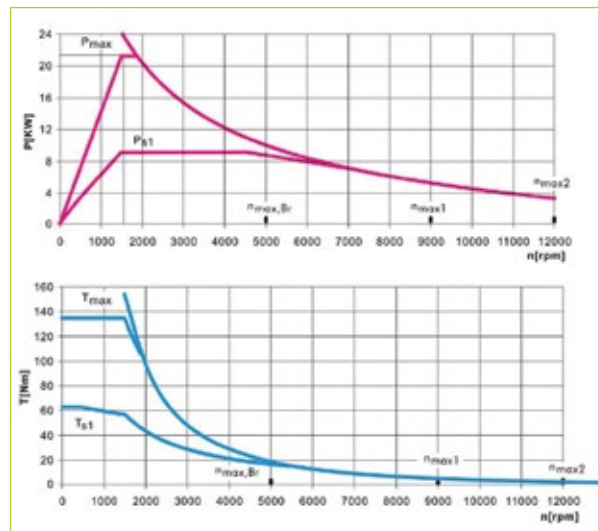

Torque diagram / Standard Siemens

GT18 · VF1100 · 24000 rpm · HSK A63

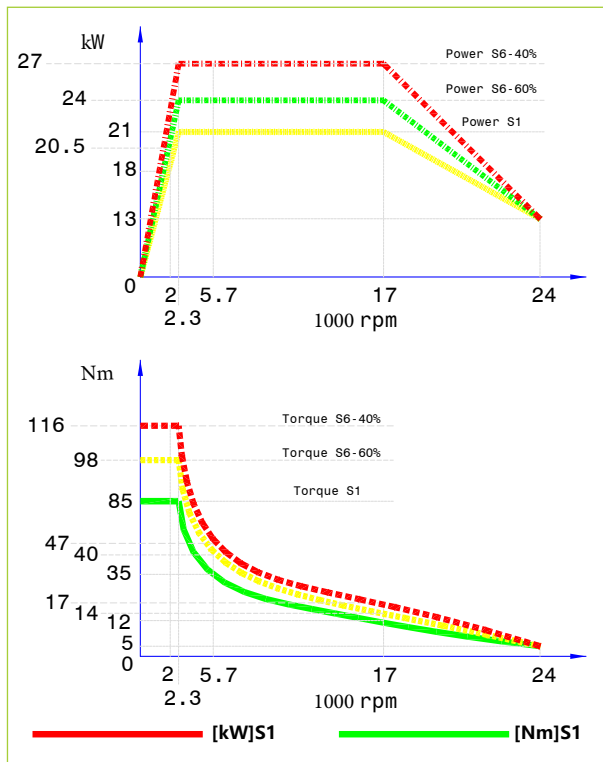

GT18 · VF1100 · 18000 rpm · HSK A63

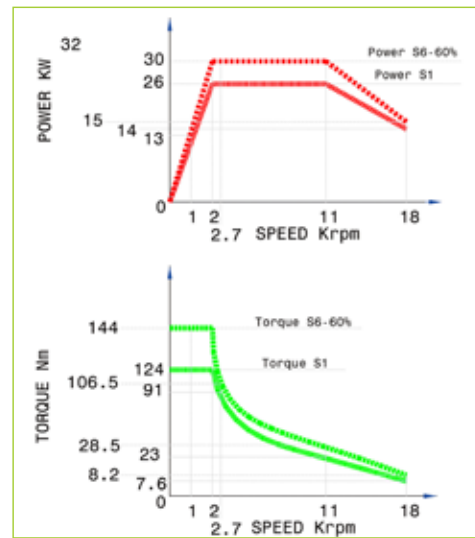

GT18-5X · 24000 rpm · HSK A63

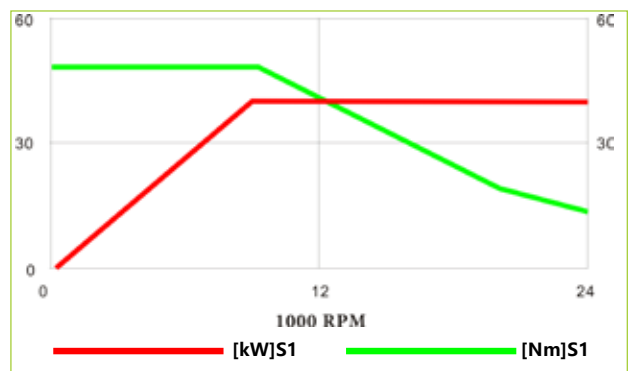

U500 · 20000 rpm · HSK A63

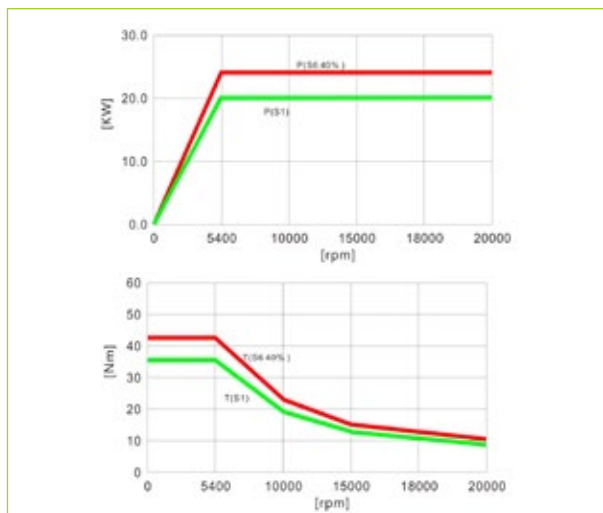

GT7 · 40000 rpm · HSK E32

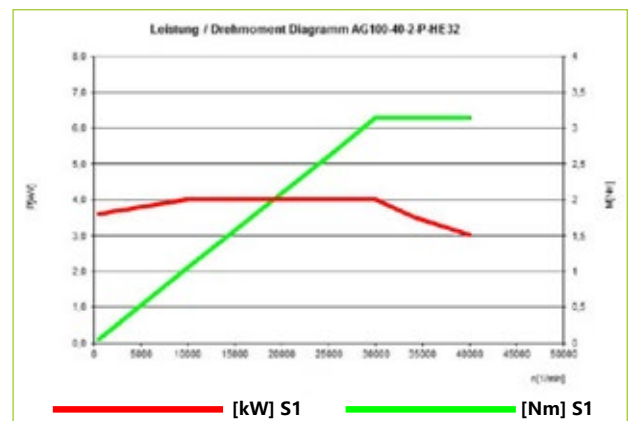

\* The above specifications are subject to change without prior notice, no liability for mistakes. Machines may be shown with optional equipment.

## Optimum structural design

- High rigidity, good performance

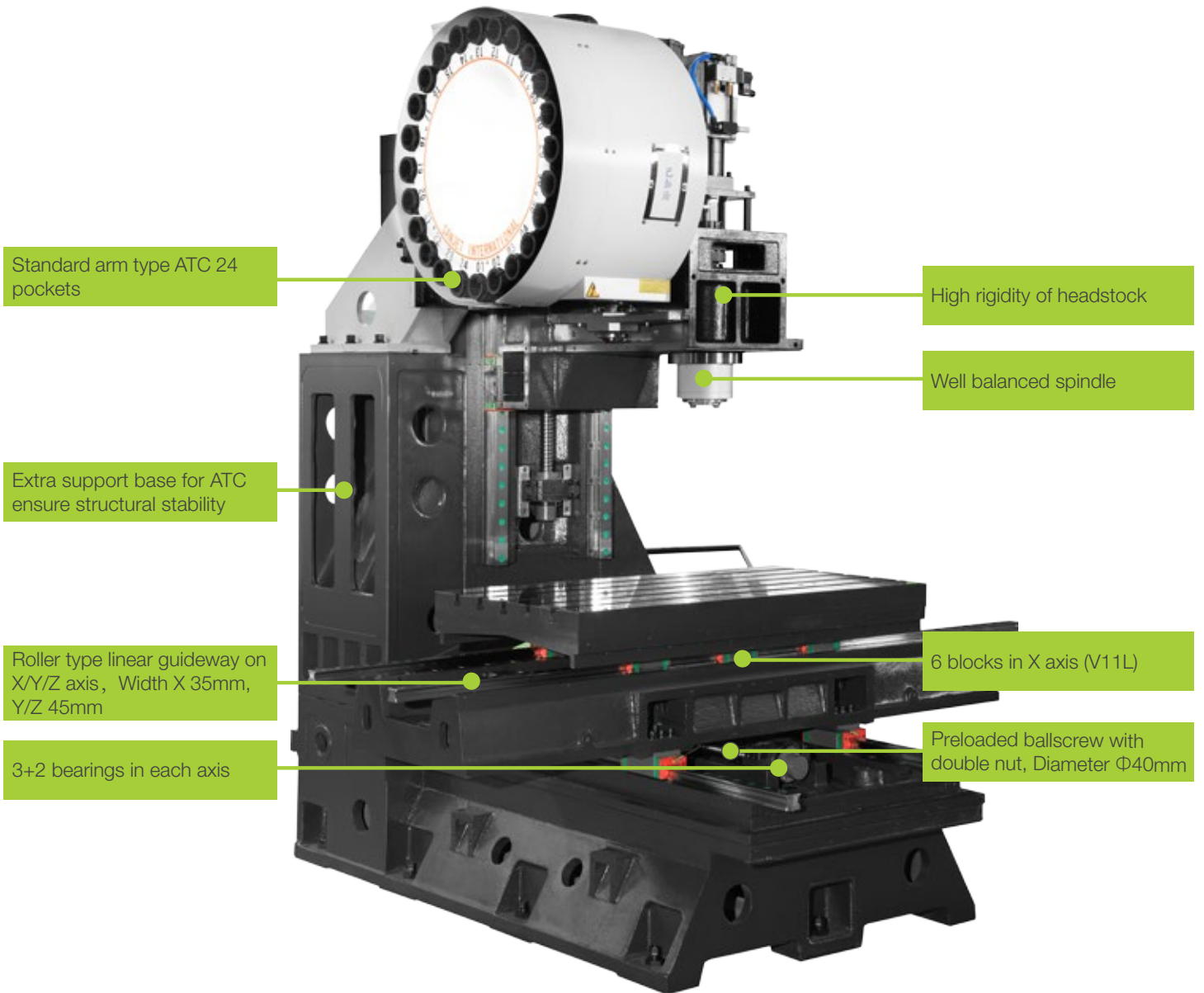

## High quality machine components

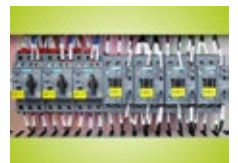

PRIMINER

NSK X HIWIN

TRR Rexroth HIWIN

NSK FAG

SANJET

SIEMENS



Measurements control during the production



Spindle unit final unbalancing inspection

Hand scraping

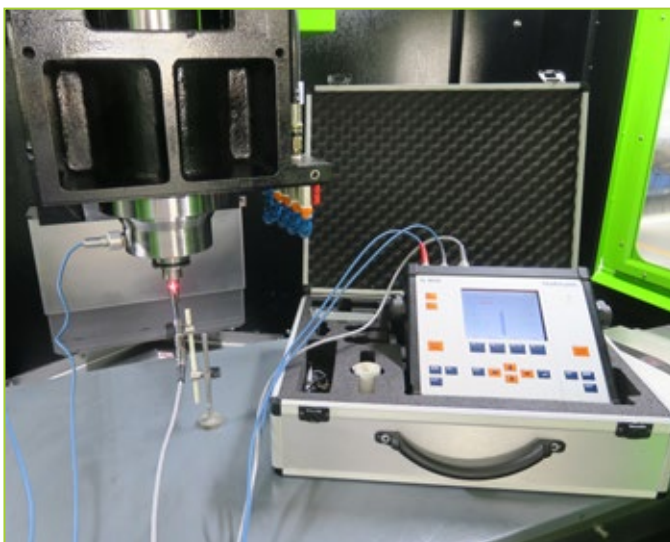

\* The above specifications are subject to change without prior notice, no liability for mistakes. Machines may be shown with optional equipment.

## 5 Axis Rotary Table

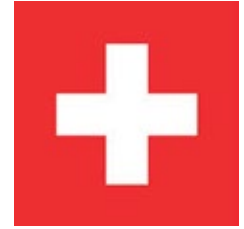

**pl** LEHMANN®





Worm shaft

Alloy steel worm gear



\* The above specifications are subject to change without prior notice, no liability for mistakes. Machines may be shown with optional equipment.



SIEMENS



HEIDENHAIN



FANUC



FAGOR

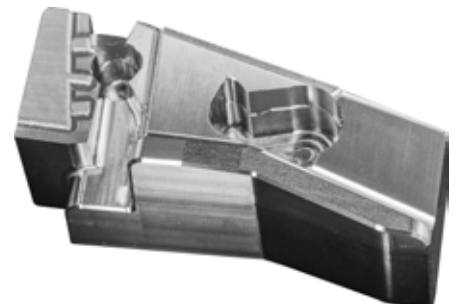
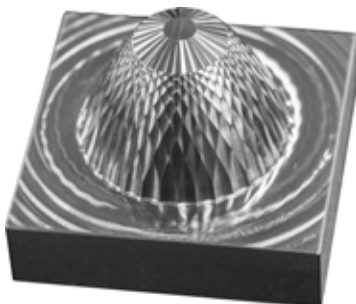
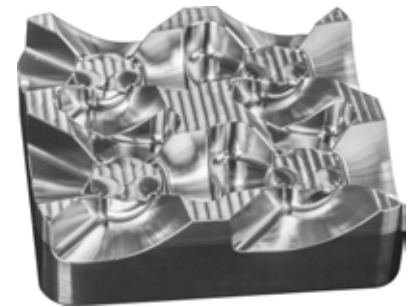
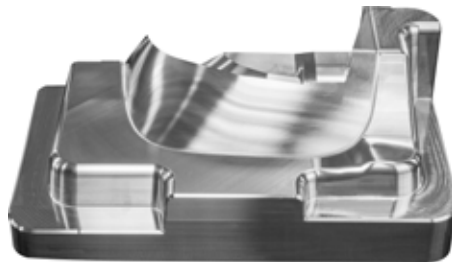
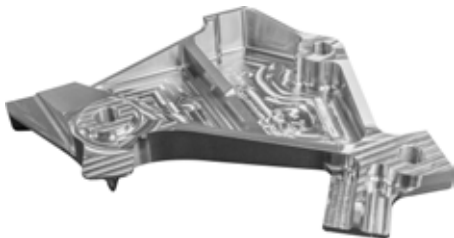
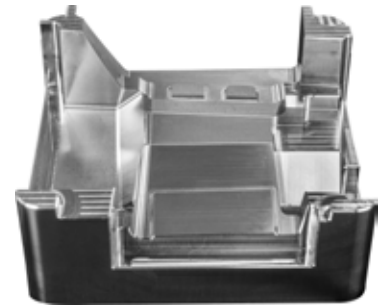
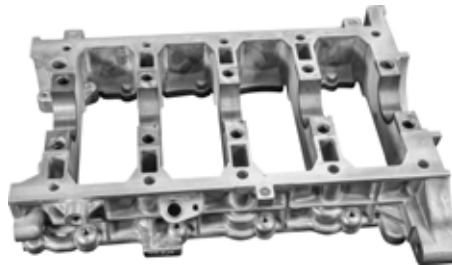
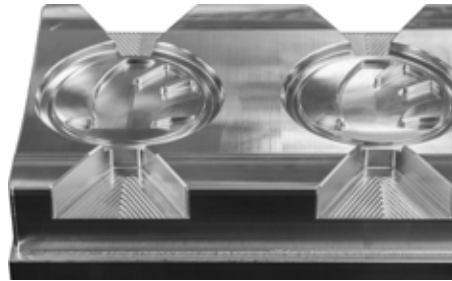

\* The above specifications are subject to change without prior notice, no liability for mistakes. Machines may be shown with optional equipment.



**SolidCAM hyperMILL**  
The Leaders in Integrated CAM  
HEXAGON | WORKNC



**LEHMANN**



**DIJET NS TOOL**  
**GÜHRING**



**SCHUNK**



**MST**



**BLUM**  
focus on productivity



**Blaser.**  
SWISSLUBE



Workpiece measuring by CMM

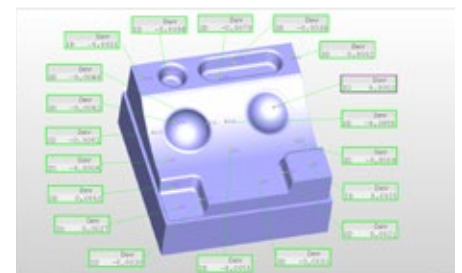
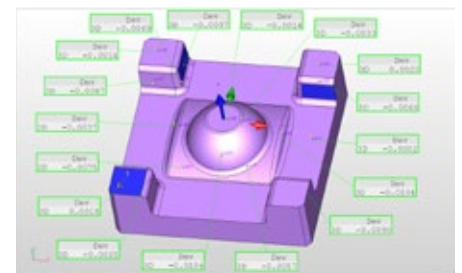
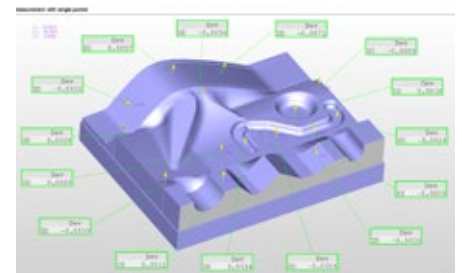

\* The above specifications are subject to change without prior notice, no liability for mistakes. Machines may be shown with optional equipment.

# PRIMINER

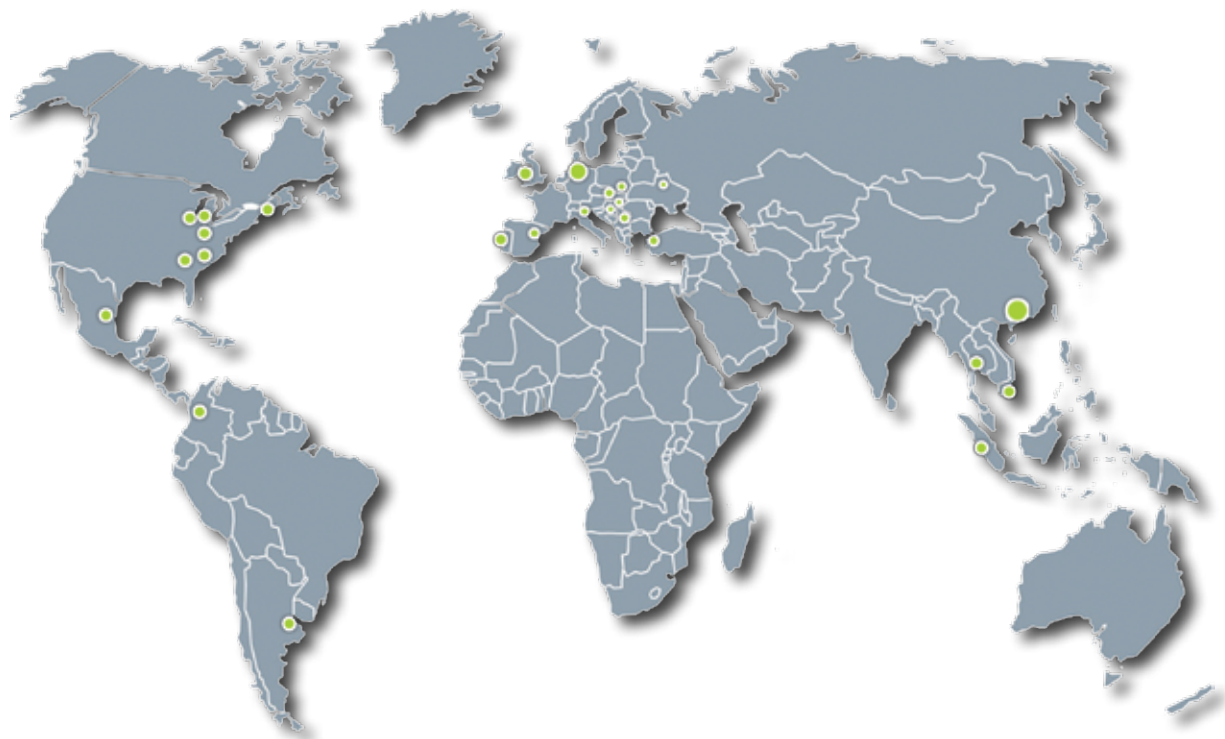

## **PRIMINER Werkzeugmaschinen GmbH**

Gadelander Str. 172 · D-24539 Neumünster / Germany

Tel: +49 (0) 4321-53 9946-0

Fax: +49 (0) 4321-25 2003-90

E-mail: [info@priminer.de](mailto:info@priminer.de)

## **PRIMINER SOUTH EAST EUROPE · PRIMINER d.o.o. BEOGRAD**

Vladimira Popovica 38-40 · GTC - 11070 Beograd / Srbija

Tel: +381 69 702 705

Fax: +381 11 715 69 00

E-mail: [office@priminer.de](mailto:office@priminer.de)

## **PRIMINER MACHINE TOOLS DONGGUAN CO., LTD**

XinRuYi Industrial Park, Fuxing Road, Xingguang Village, Huangjiang Town, Dongguan, P.R.China

Tel: +86 769 838 490 61

Fax: +86 769 838 490 62

E-mail: [export@priminer.com](mailto:export@priminer.com)

[www.priminer.de](http://www.priminer.de)